

Assembly Instructions

Scali Series

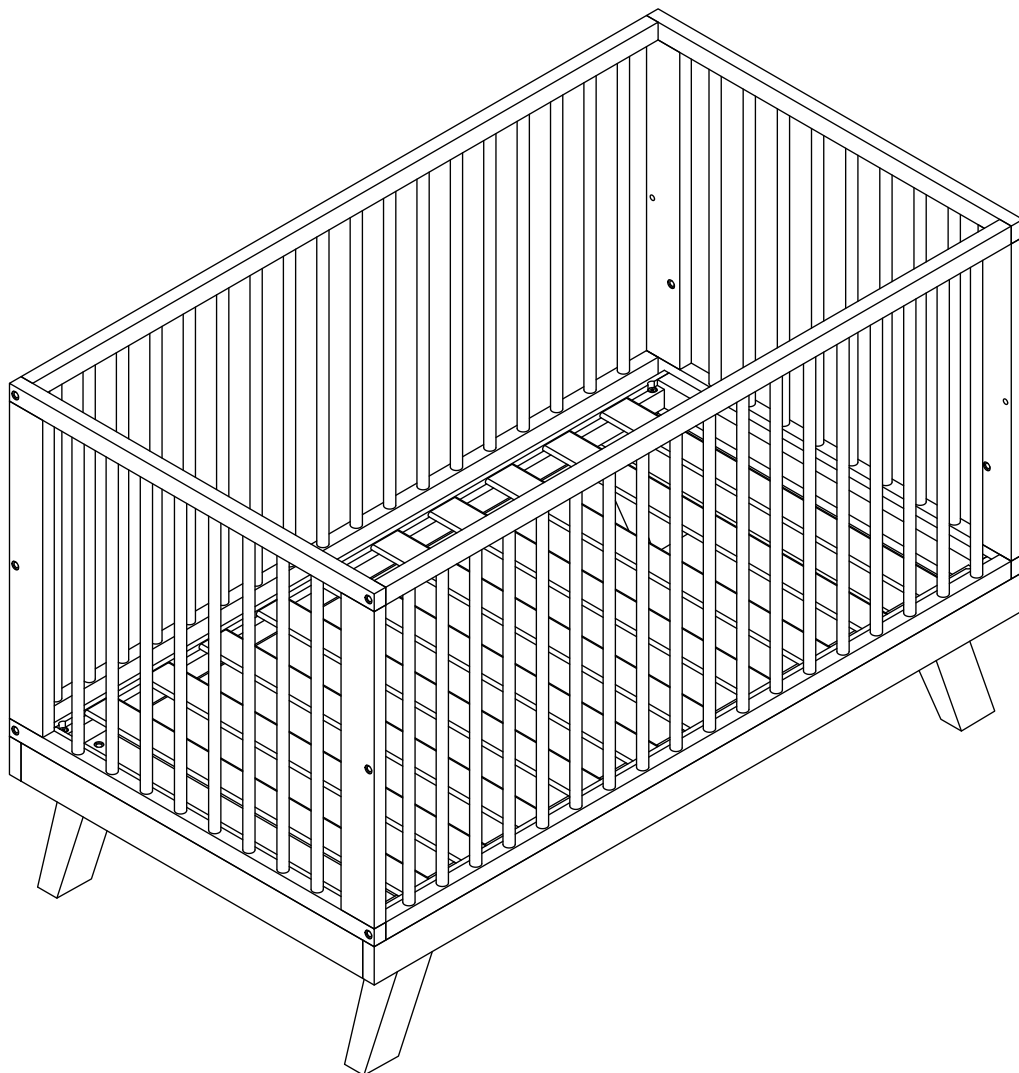

Lifely*

Product Code
SD-COT1010-WHITE

Dimensions(W x D x H)
1350 x 760 x 900 mm

Important

Please read through instruction carefully
Before assembly and keep for future reference.

For our full catalogue of assembly instructions,
Visit: lifely.com.au/assembly.

Important Tips and Maintenance



1.
Keep children and animals away from working area as smaller parts may cause choking if swallowed.

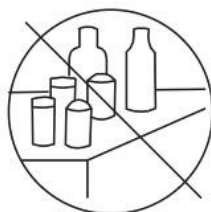

2.
Never place liquids or anything damp upon furniture as it will mark. Ensure a coaster or running is beneath.



3.
Never use ammonia based cleaning products as it will damage the finish.

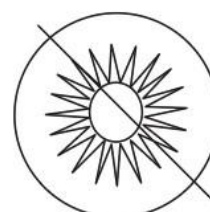

4.
To avoid fading, keep furniture out of direct sunlight.



5.
Use a soft or damp cloth (dry cloth) when wiping or cleaning surfaces.



6.
Two person are required.



7.
Lay a soft matt down to protect the furniture piece before and during assembly.

So your relationship is strong. But is it flat-pack furniture strong? Unless you're an aerospace engineer, assembling furniture can be slightly stressful. We recommend meditating quietly, pouring yourself a herbal tea (or slightly less herbal wine) and tackling things one step at a time. If you feel a passive aggressive remark coming on, try a compliment instead. E.g. "You're so good looking".

This 6-Step assembly should take around 35 minutes with an Allen Key.
Godspeed.

Designed for everyday

Component Hardware

Please check you have all the fittings
part or tools are listed in below.

NO.A

Quantity: 6 Pcs
Screw M6*50mm



NO.B

Quantity: 16 Pcs
Screw M6*40mm



NO.C

Quantity: 8 Pcs
Screw M6*15mm



NO.D

Quantity: 4 Pcs
Nut



NO.E

Quantity: 4 Pcs
Dowel



NO.F

Quantity: 4 Pcs
Mattress Pin

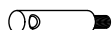

NO.G

Quantity: 1 Pc
Allen Key M6



Component Panels & Part List

Please check you have all the panels
are listed below.

1. Crib End ----- x2

2. Crib Rail ----- x2

3. Mattress Base ----- x1

4. Frame ----- x1

5. Leg ----- x4

6. Bedguard ----- x1

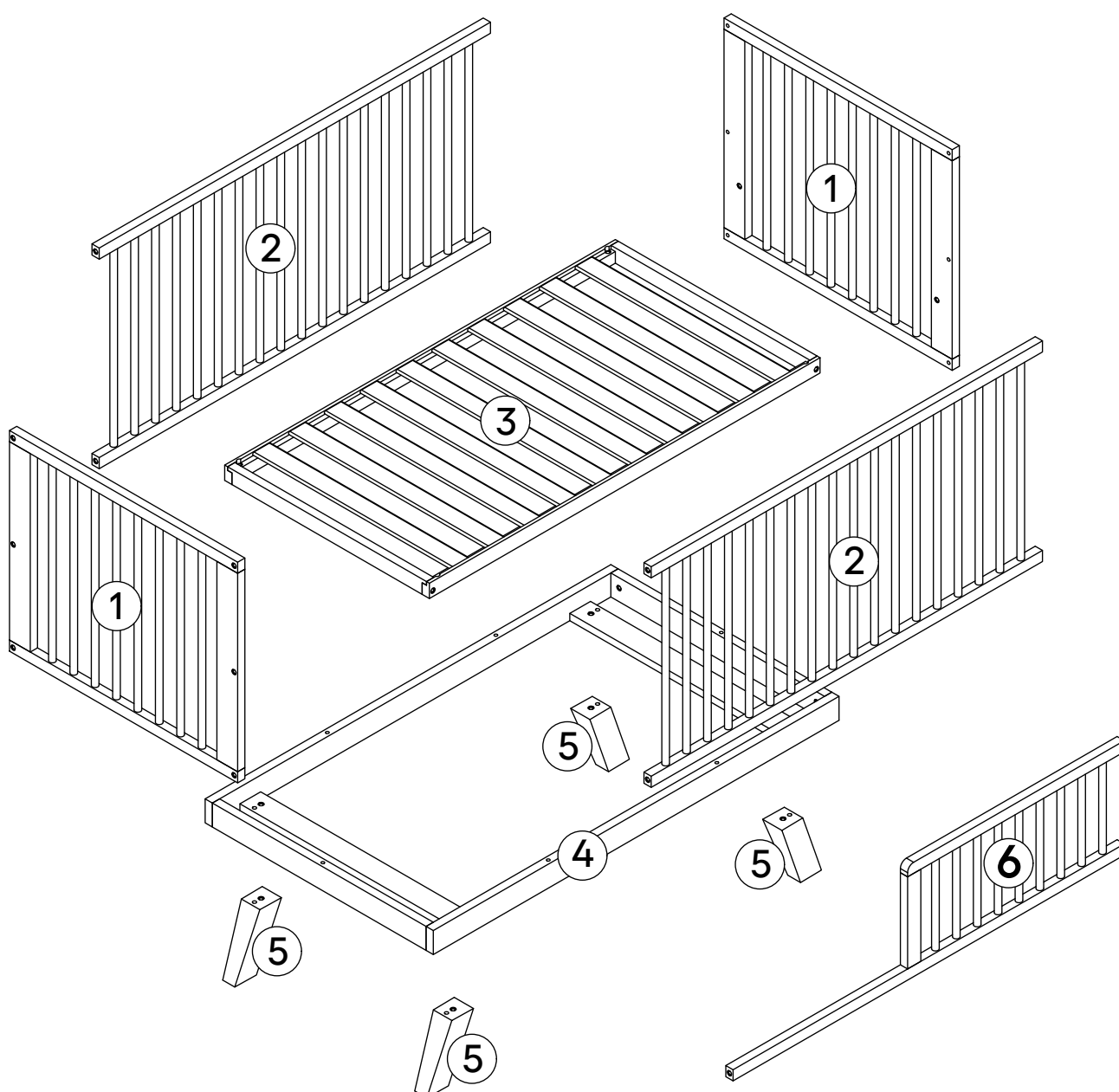

STEP 1

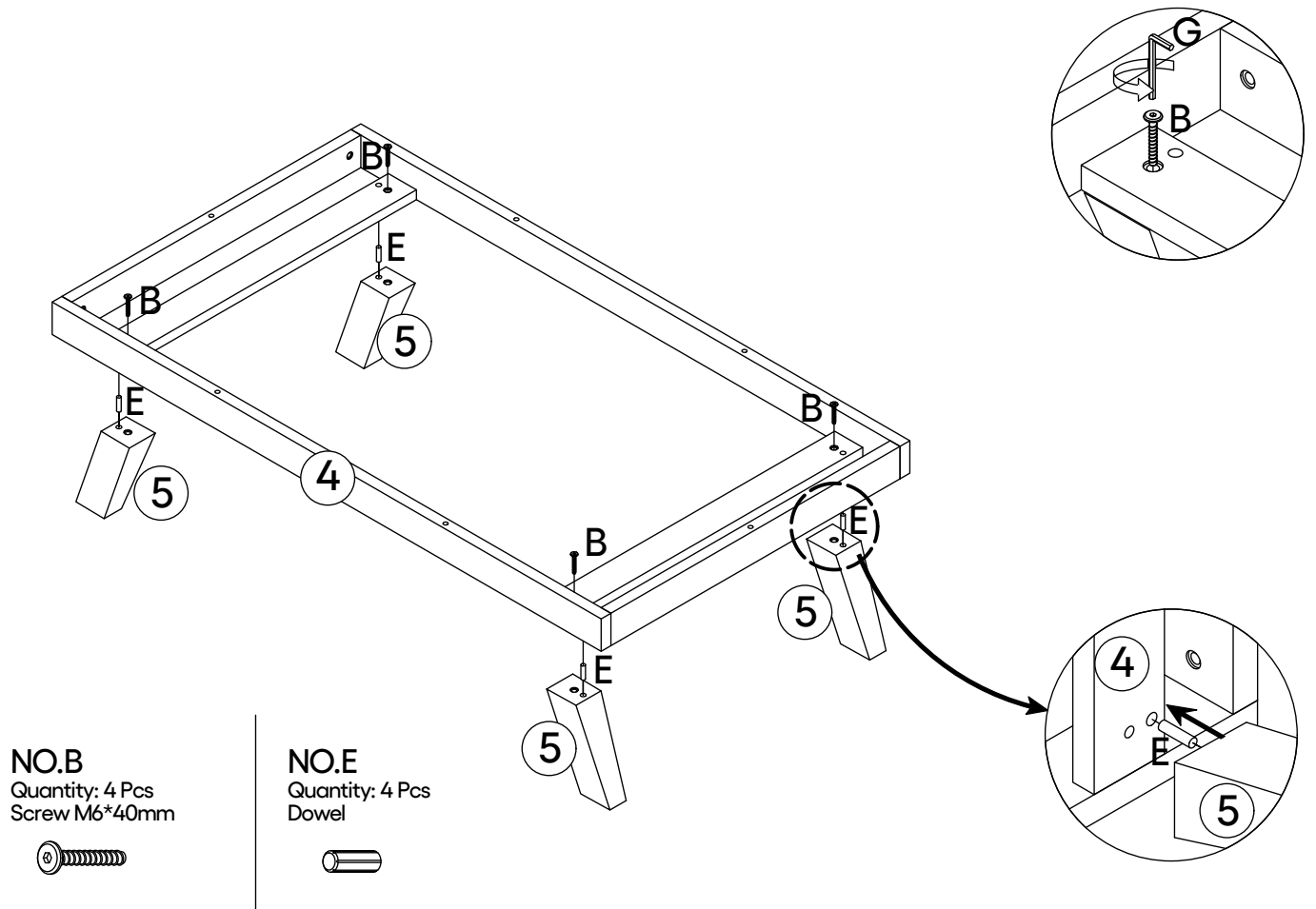

STEP 2

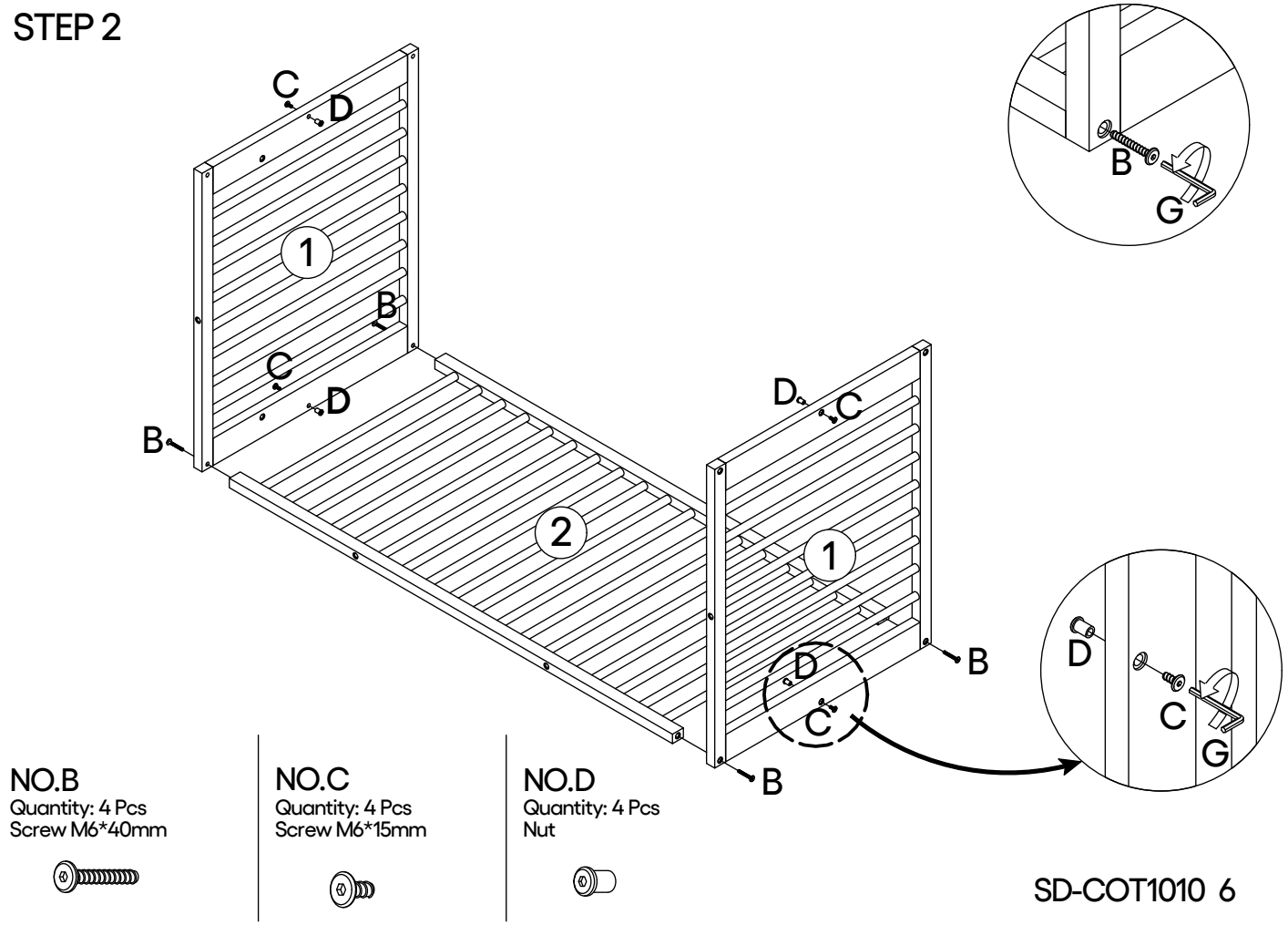

STEP 3

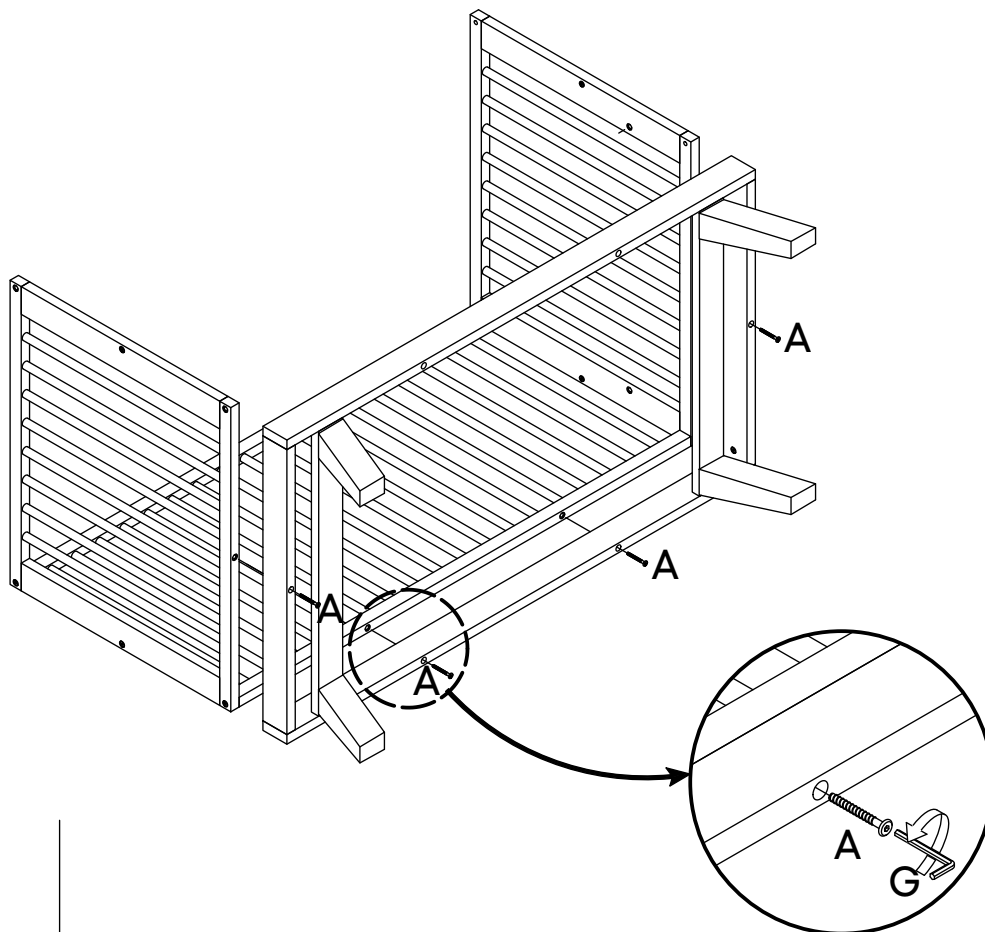

NO.A

Quantity: 4 Pcs
Screw M6*50mm



STEP 4

HIGHEST POSITION

LOWEST POSITION

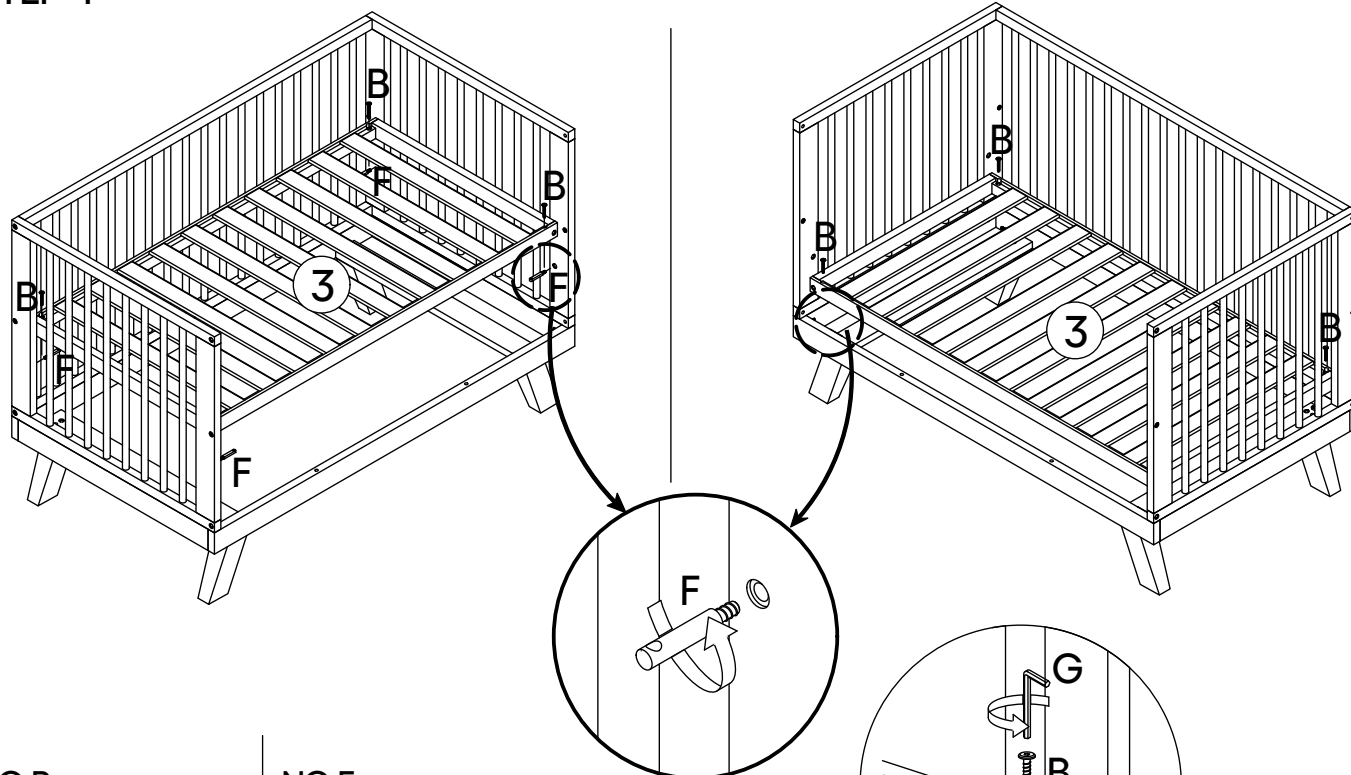

NO.B

Quantity: 4 Pcs
Screw M6*40mm



NO.F

Quantity: 4 Pcs
Mattress Pin

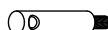

SD-COT1010 7

STEP 5

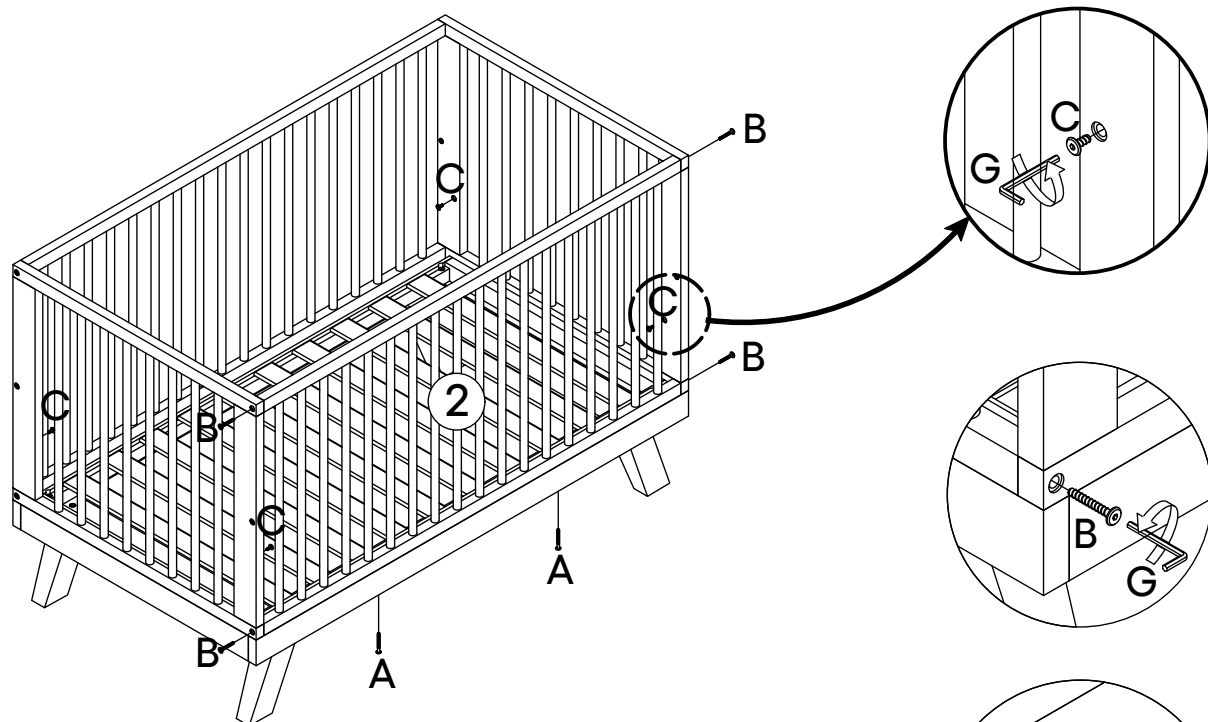

NO.A

Quantity: 2 Pcs
Screw M6*50mm



NO.B

Quantity: 4 Pcs
Screw M6*40mm



NO.C

Quantity: 4 Pcs
Screw M6*15mm



STEP 6

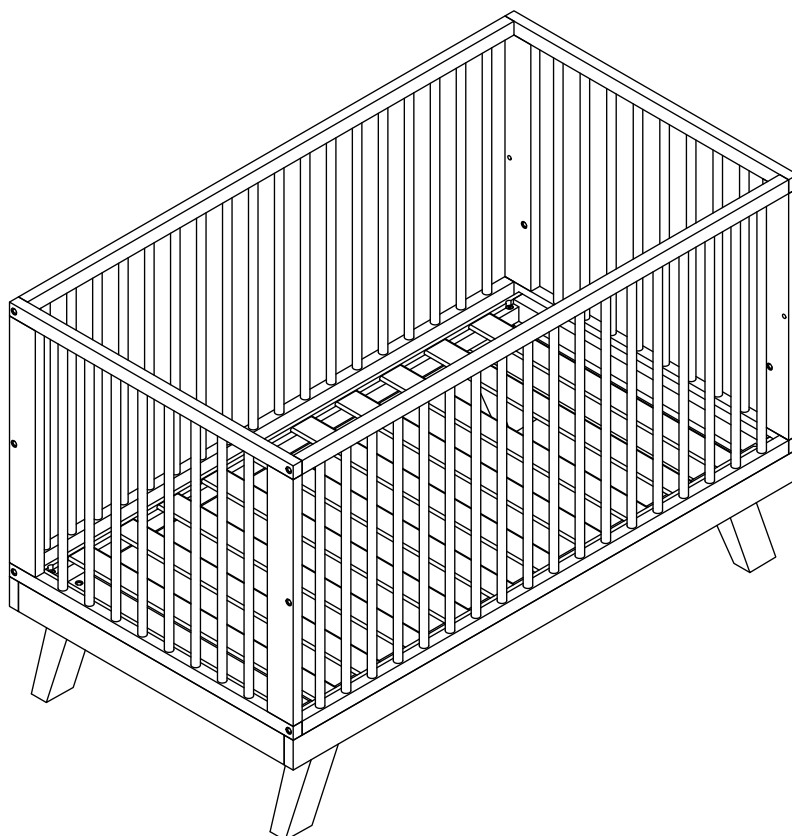

HOW TO CHANGE CRIB TO TODDLER BED

STEP 1

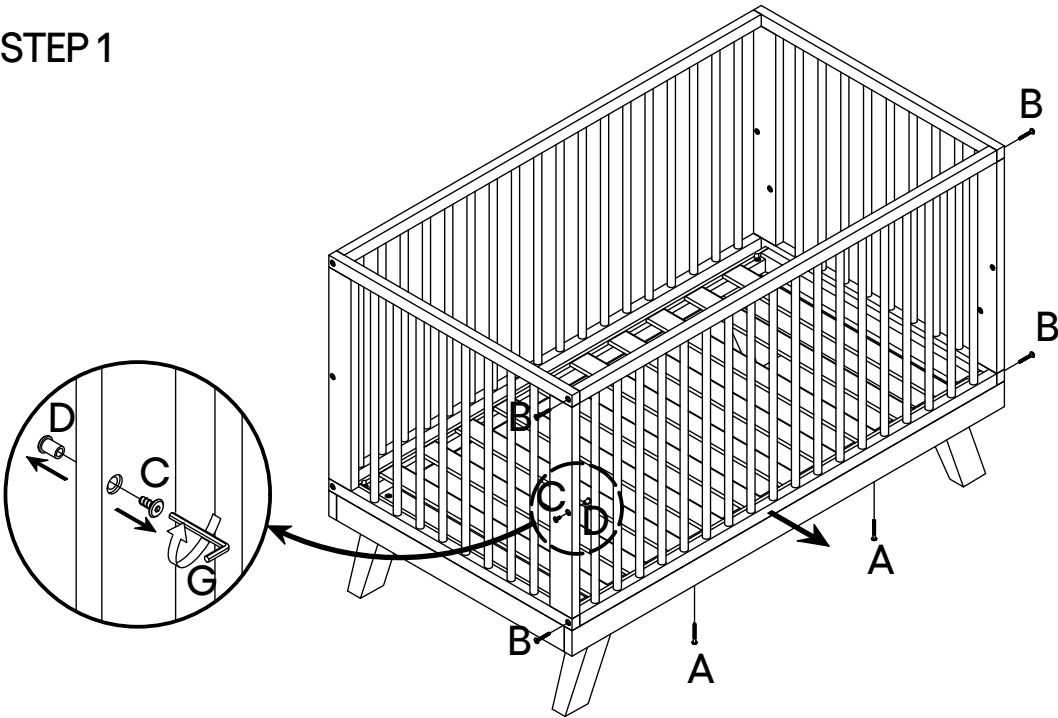

NO.A
Quantity: 2 Pcs
Screw M6*50mm



NO.B
Quantity: 4 Pcs
Screw M6*40mm



NO.C
Quantity: 1 Pc
Screw M6*15mm



NO.D
Quantity: 1 Pc
Nut

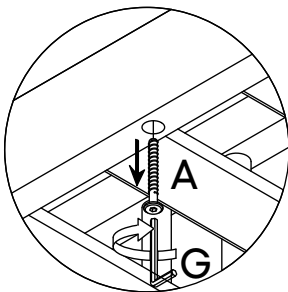
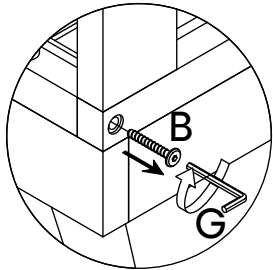

STEP 2

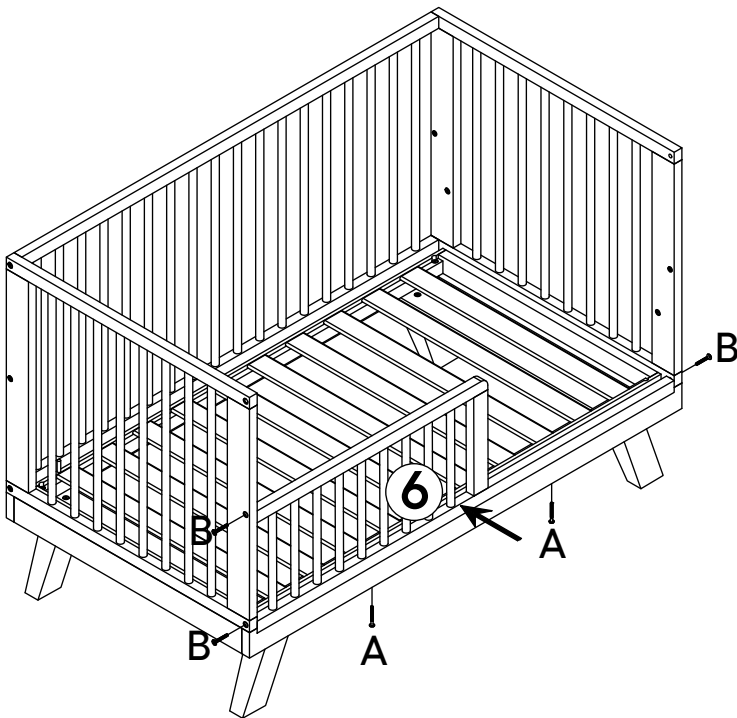

NO.A
Quantity: 2 Pcs
Screw M6*50mm



NO.B
Quantity: 3 Pcs
Screw M6*40mm

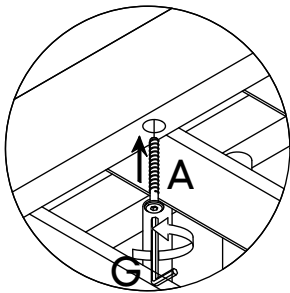
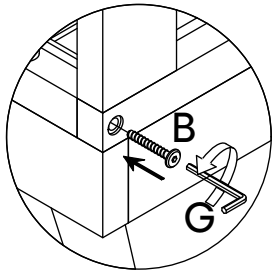

Great job. You're done!

Don't forget to share how it looks in
your space and tag us on Instagram.
@lifelyhome#homewithlifely!