

# Assembly Instructions

## Tate Series

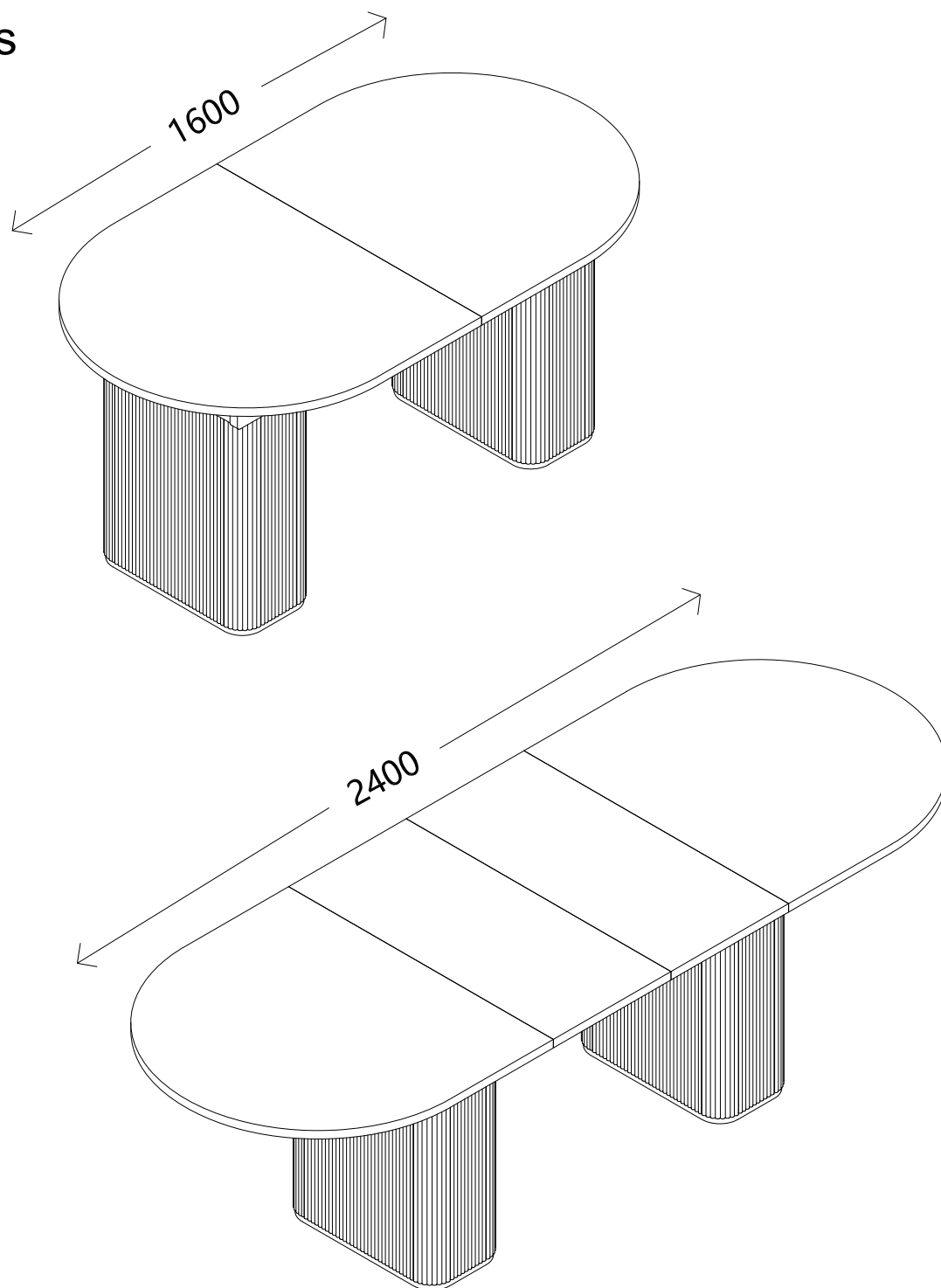

# Lifely\*

### Product Code

TATE-EDT-BLK Tate Extendable Dining Table

### Dimensions(W x D x H)

1600/2400\*900\*750mm

### Important

Please read through instruction carefully  
Before assembly and keep for future reference.  
For our full catalogue of assembly instructions,  
Visit: [lifely.com.au/assembly](https://lifely.com.au/assembly).

## Important Tips and Maintenance

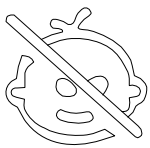

1.  
Keep children and animals away from working area as smaller parts may cause choking if swallowed.

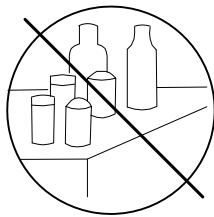

2.  
Never place liquids or anything damp upon furniture as it will mark. Ensure a coaster or running is beneath.

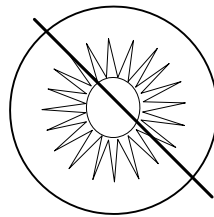

3.  
To avoid fading, keep furniture out of direct sunlight.



4.  
Never use ammonia based cleaning products as it will damage the finish.

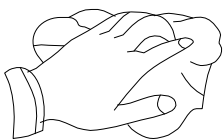

5.  
Use a soft or dry cloth when wiping or cleaning surfaces.

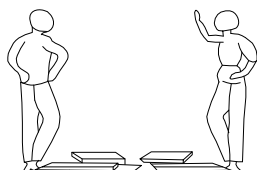

6.  
Two person are required.

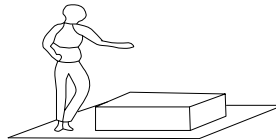

7.  
Lay a soft matt down to protect the furniture piece before and during assembly.

So your relationship is strong. But is it flat-pack furniture strong? Unless you're an aerospace engineer, assembling furniture can be slightly stressful. We recommend meditating quietly, pouring yourself a herbal tea (or slightly less herbal wine) and tackling things one step at a time. If you feel a passive aggressive remark coming on, try a compliment instead. E.g. "You're so good looking."

This 7-step assembly should take around 50 minutes with an Allen key-or 39 minutes with an electric drill.

Designed for everyday

Component Hardware are in box one.  
Please check you have all the fittings  
part or tools are listed in below.

No. A  
Quantity:33 Pcs  
Cam  
Ø15\*12mm



No. B  
Quantity:33 Pcs  
Cam Lock Dowel  
Ø7\*25



No. C  
Quantity:8 Pcs  
Screw  
M6\*25

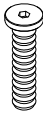

No. D  
Quantity:8 Pcs  
Shelf Dowel  
M5\*20



No. E  
Quantity:32 Pcs  
Wooden Dowel  
Ø8\*30mm



No. F  
Quantity:12 Pcs  
Screw  
Ø7\*38mm



No. G  
Quantity:33 Pcs  
Cover  
Ø20mm



No. H  
Quantity:12 Pcs  
EVA Pad  
Ø25



No. I  
Quantity:1 Pc  
Key  
5mm



No. J  
Quantity:1 Pc  
Key  
4mm

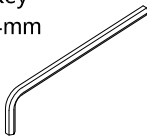

No. K  
Quantity:4 Pcs  
Screw  
M6\*30



## Component Panels & part List

Please check you have all the panels  
are listed below.

- |                           |    |         |
|---------------------------|----|---------|
| 1. Top Frame-----         | x1 | CTN 3/3 |
| 2. Top Panel-Middle----   | x2 | CTN 1/3 |
| 3. Side Panel-Smaller---- | x4 | CTN 1/3 |
| 4. Side Panel-Biger-----  | x4 | CTN 2/3 |
| 5. Corner Leg-----        | x8 | CTN 2/3 |
| 6. Leg Top-----           | x2 | CTN 1/3 |
| 7. Bottom-----            | x2 | CTN 1/3 |
| 8. Side panel-Top-----    | x2 | CTN 3/3 |

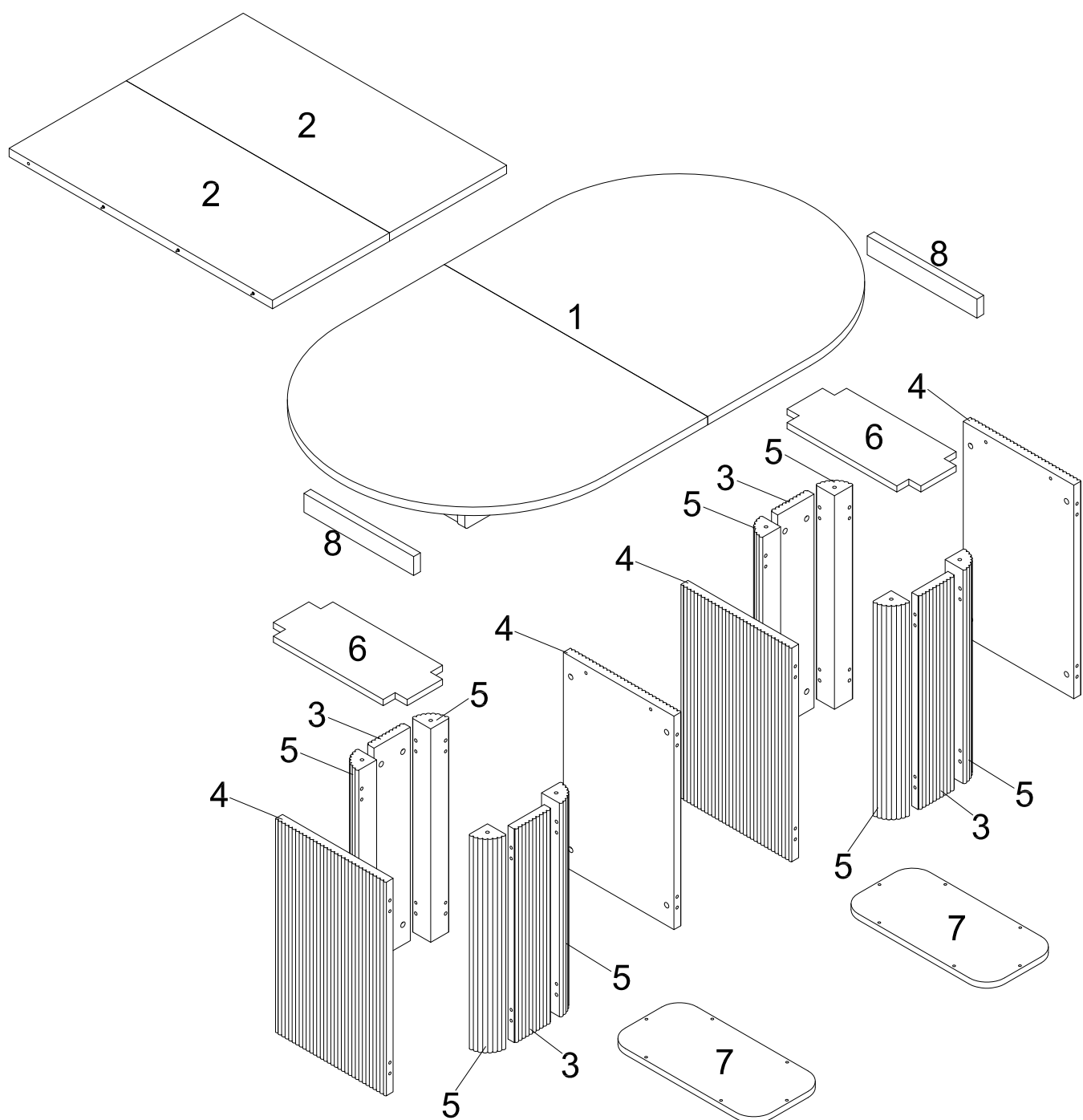

## STEP 1

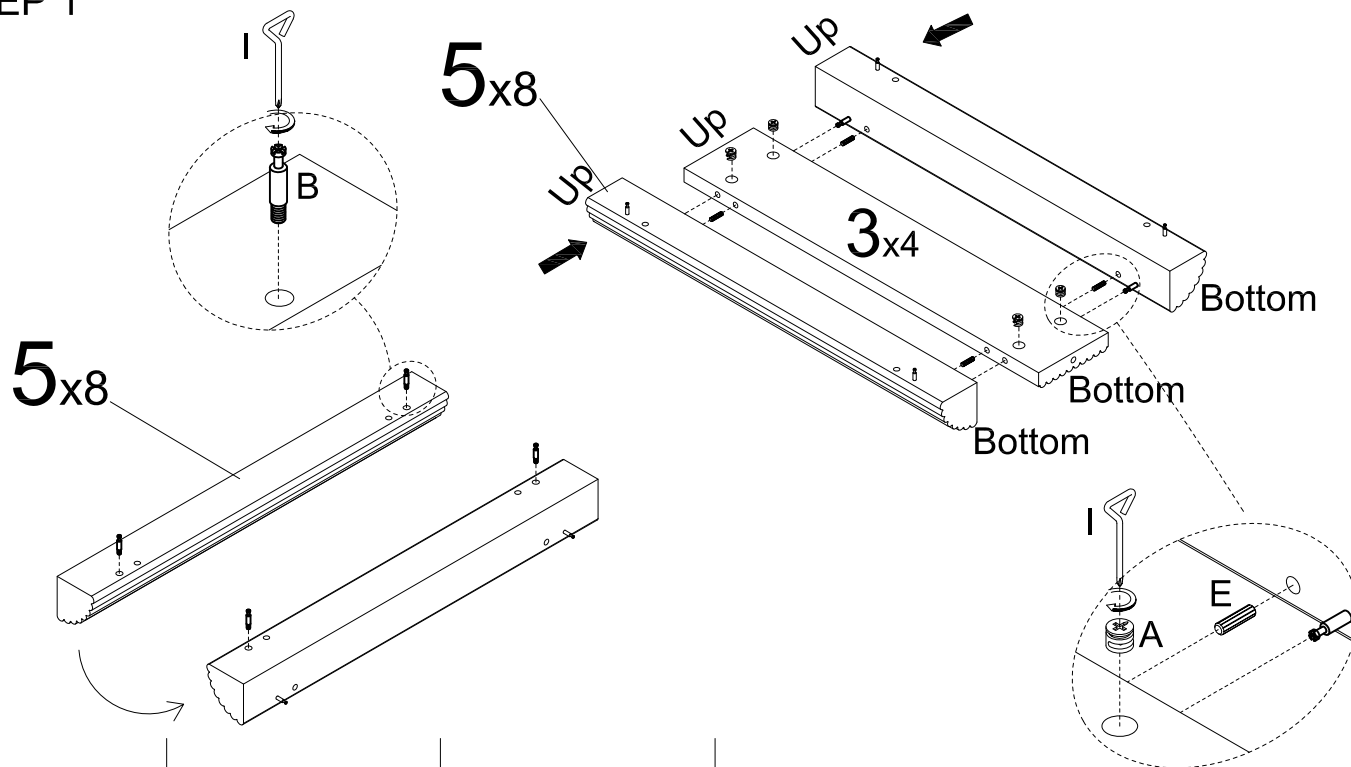

No. A  
Quantity: 16 Pcs



No. B  
Quantity: 32 Pcs

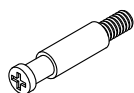

No. E  
Quantity: 16 Pcs

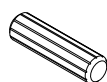

No. I  
Quantity: 1 Pc

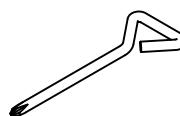

## STEP 2

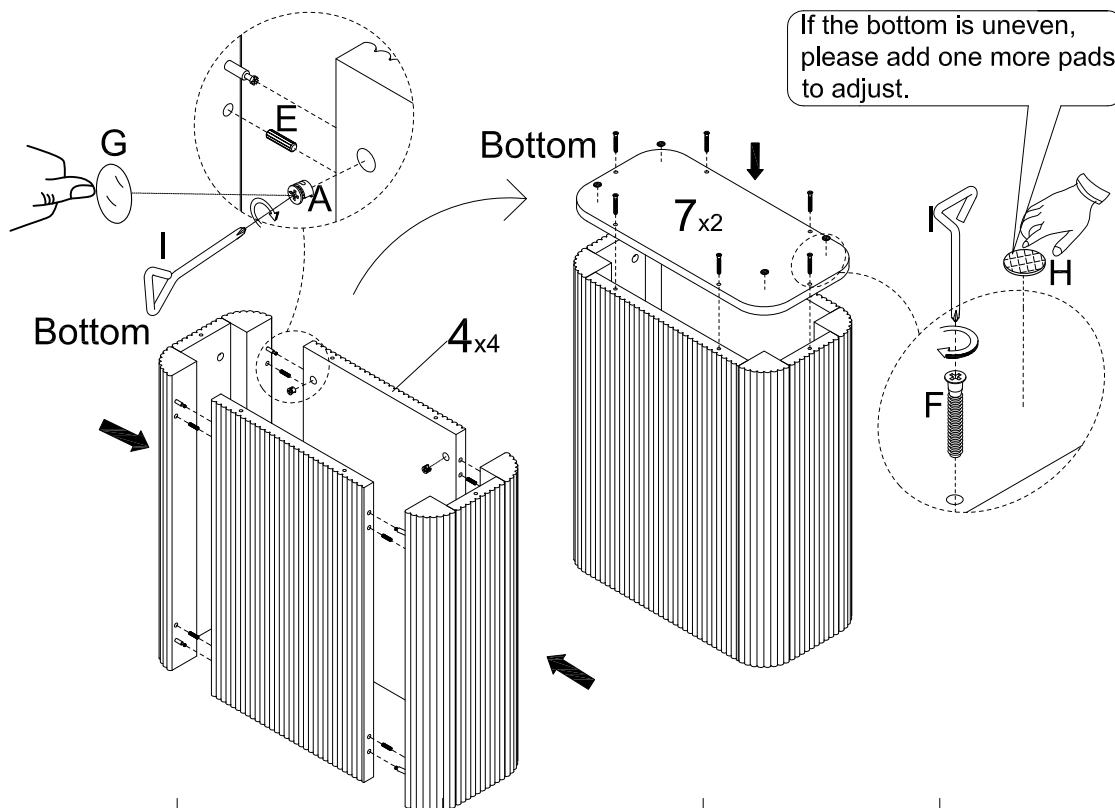

No. A  
Quantity: 16 Pcs



No. E  
Quantity: 16 Pcs

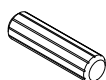

No. F  
Quantity: 12 Pcs



No. G  
Quantity: 32 Pcs



No. H  
Quantity: 8 Pcs



No. I  
Quantity: 1 Pc

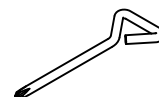

## STEP 3

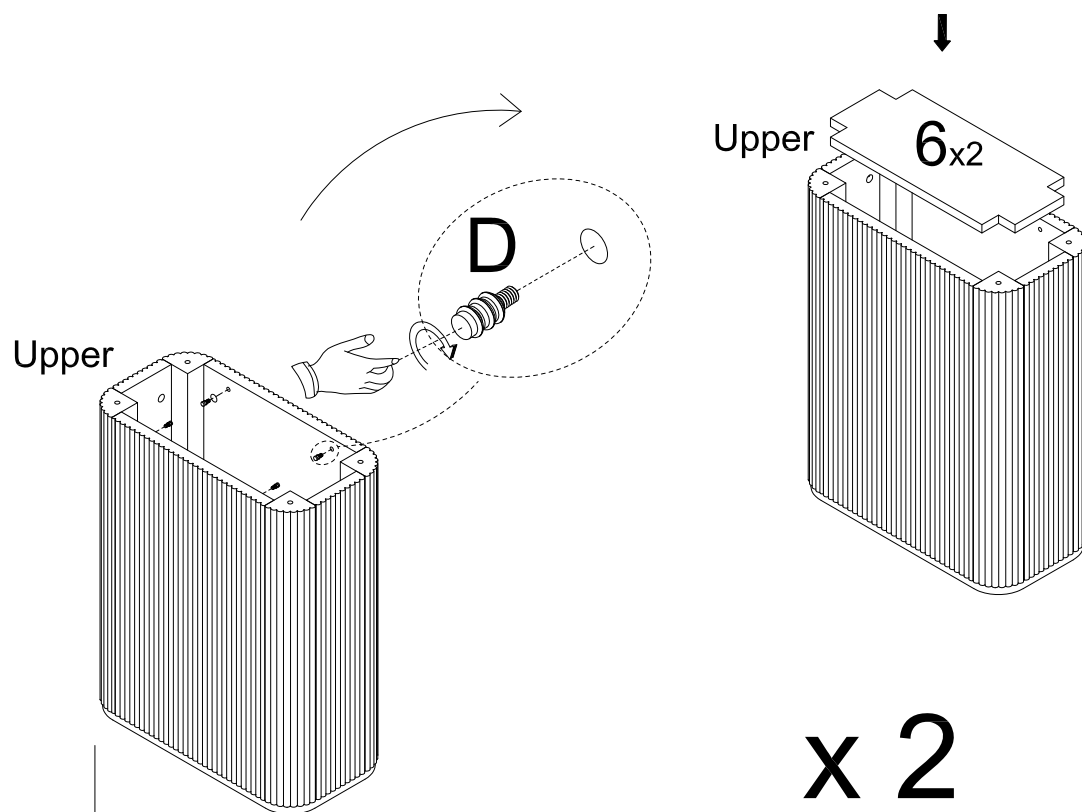

No. D  
Quantity: 8 Pcs

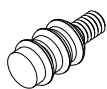

## STEP 4

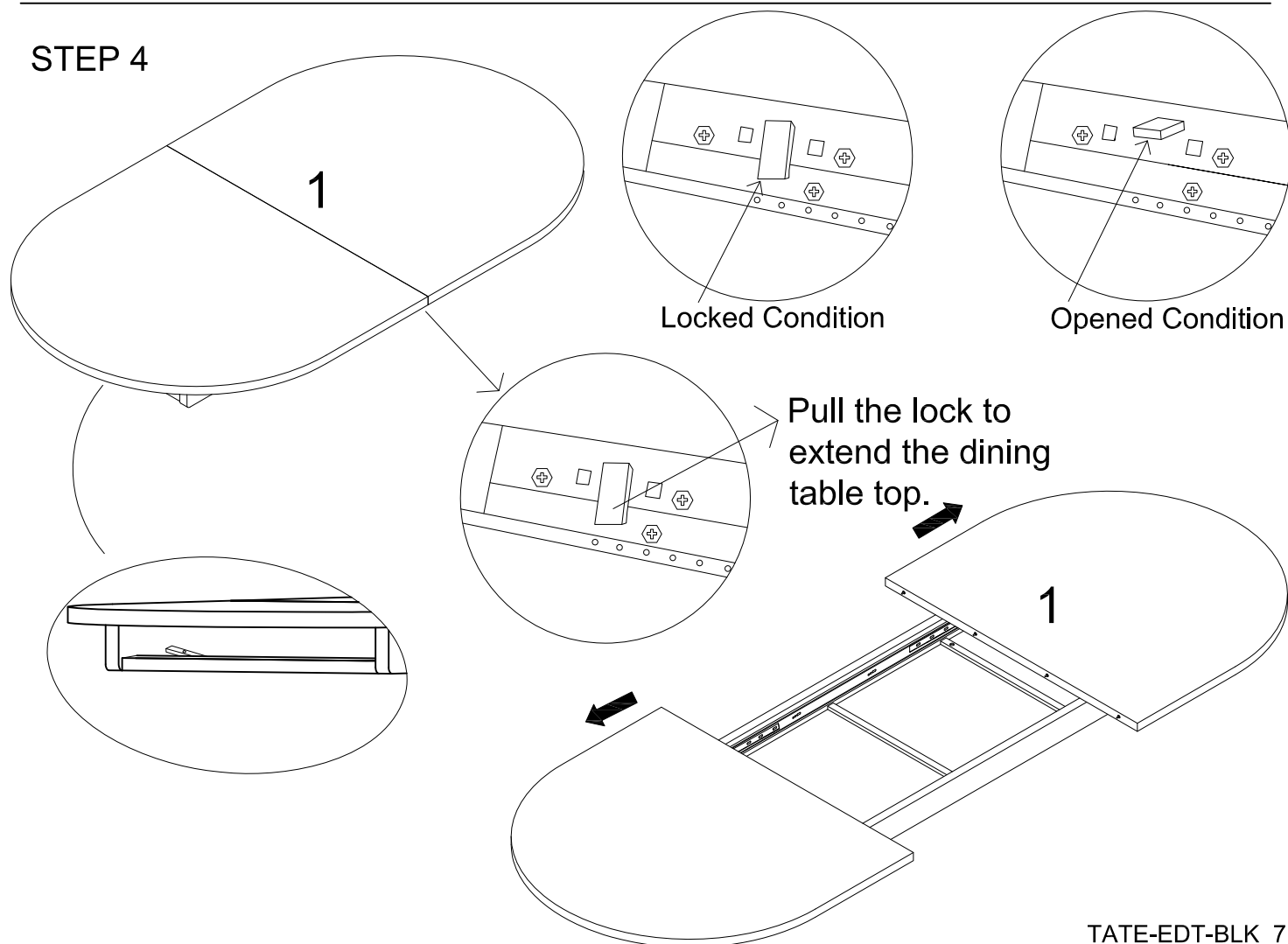

## STEP 5

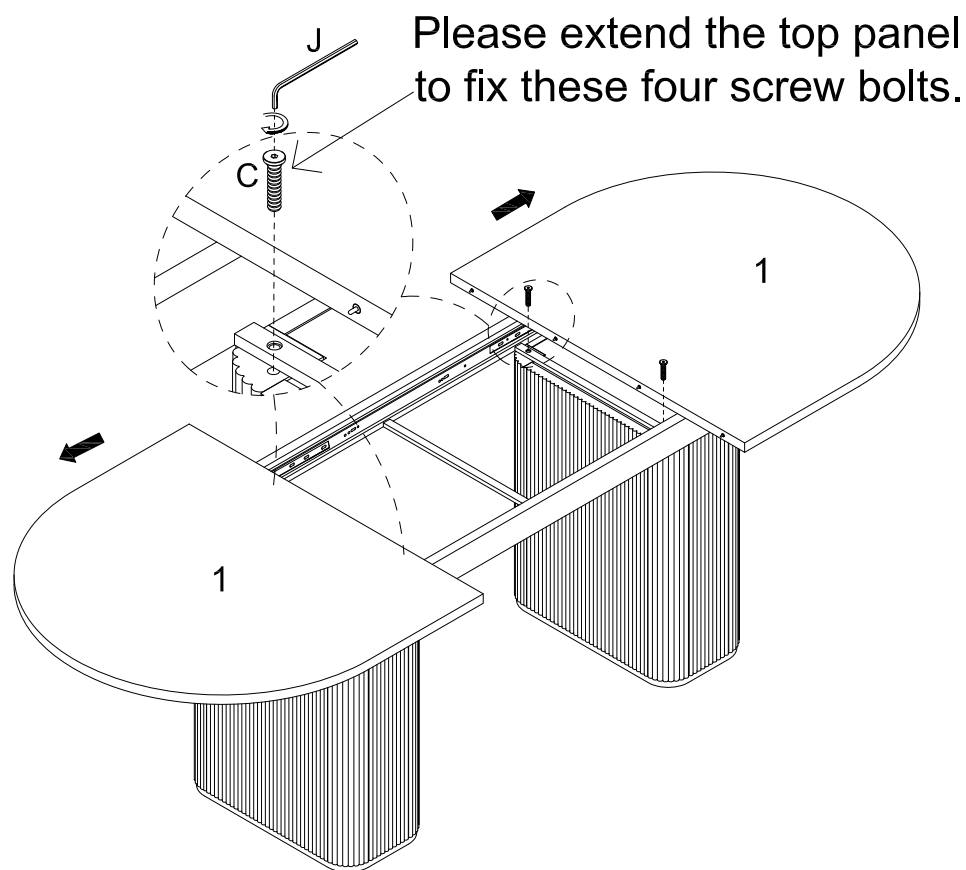

No. C  
Quantity:4 Pcs

No. J  
Quantity:1 Pc

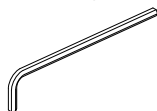

## STEP 6

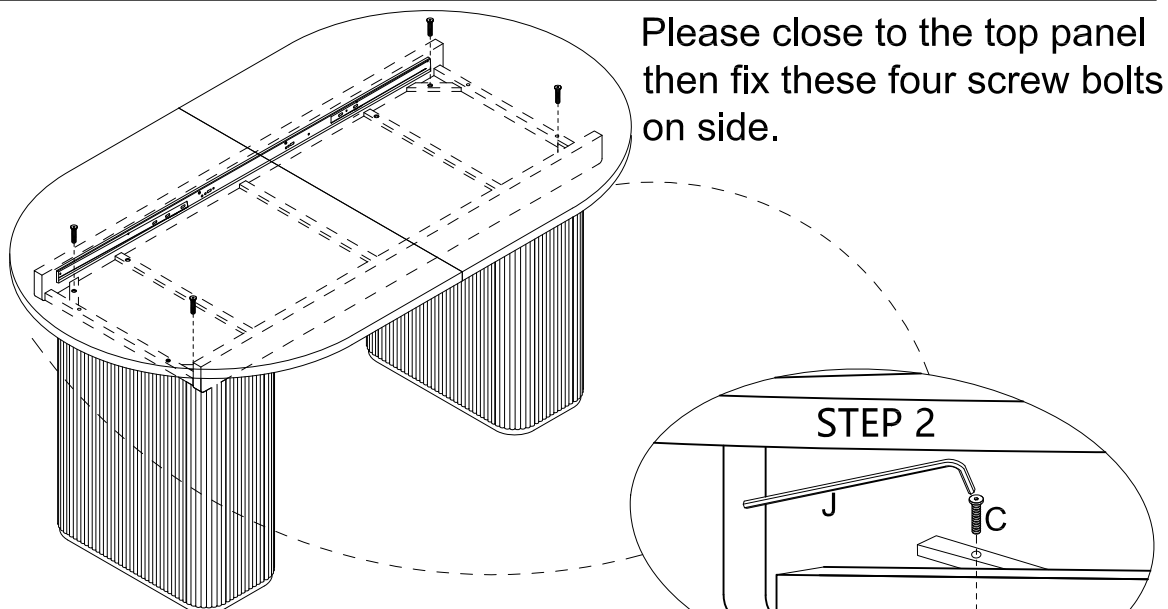

No. C  
Quantity:4 Pcs

No. J  
Quantity:1 Pc

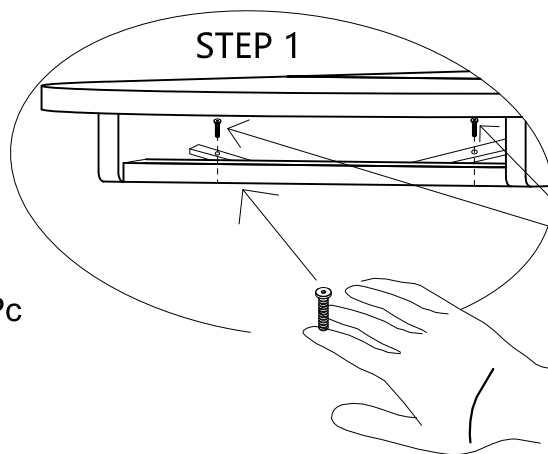
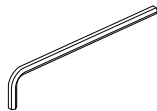

Please put these screw bolts into hole by hand first, then tighten them with an Allen key.

STEP 7

Put the top middle panel on top frame, please note the position as below:

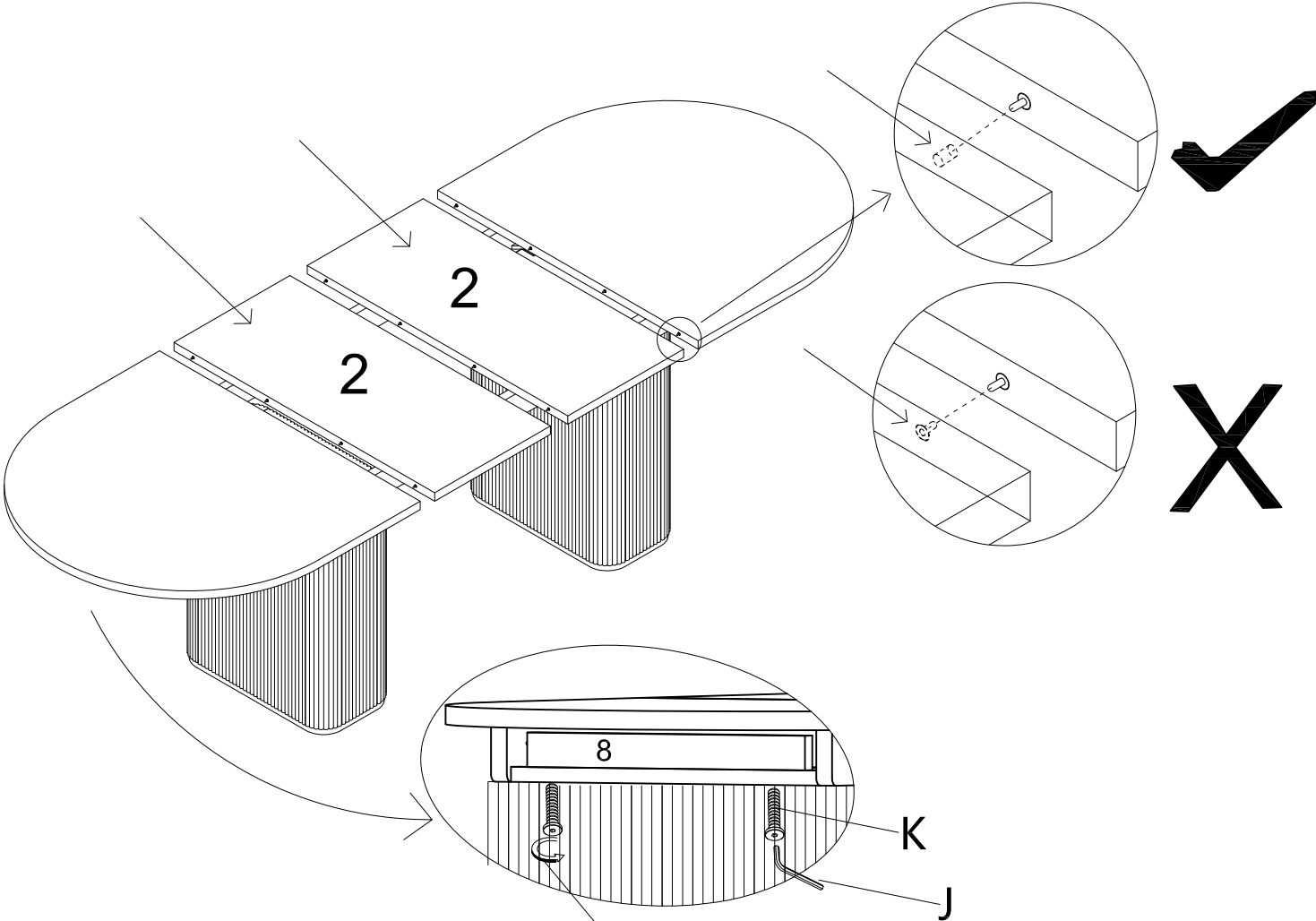

No. K  
Quantity:4 Pcs

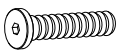

No. J  
Quantity:1 Pc



Tighten these screws to  
fix the side panel "8"

## Option 1:

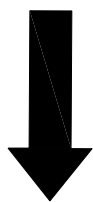
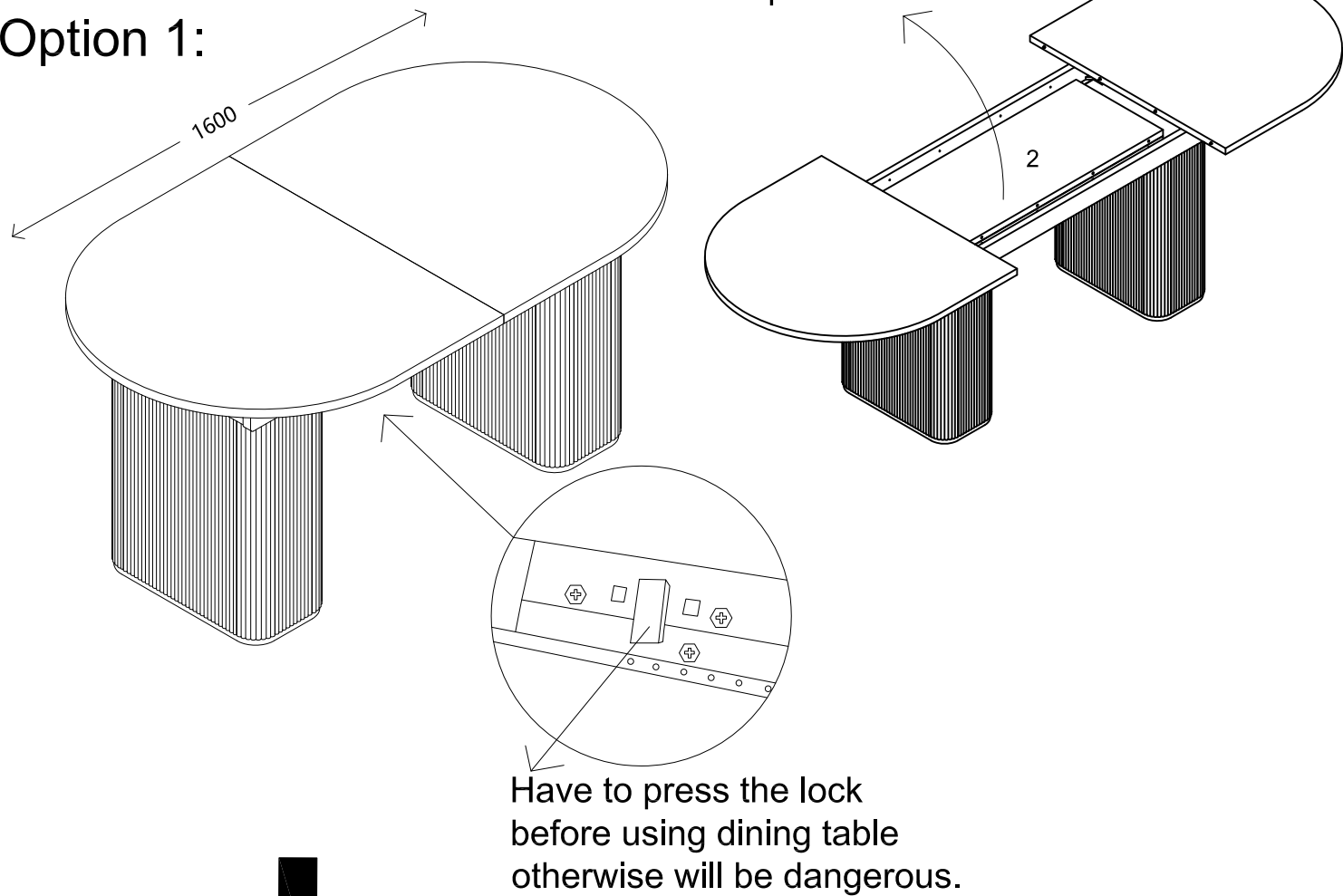

## Option 2:

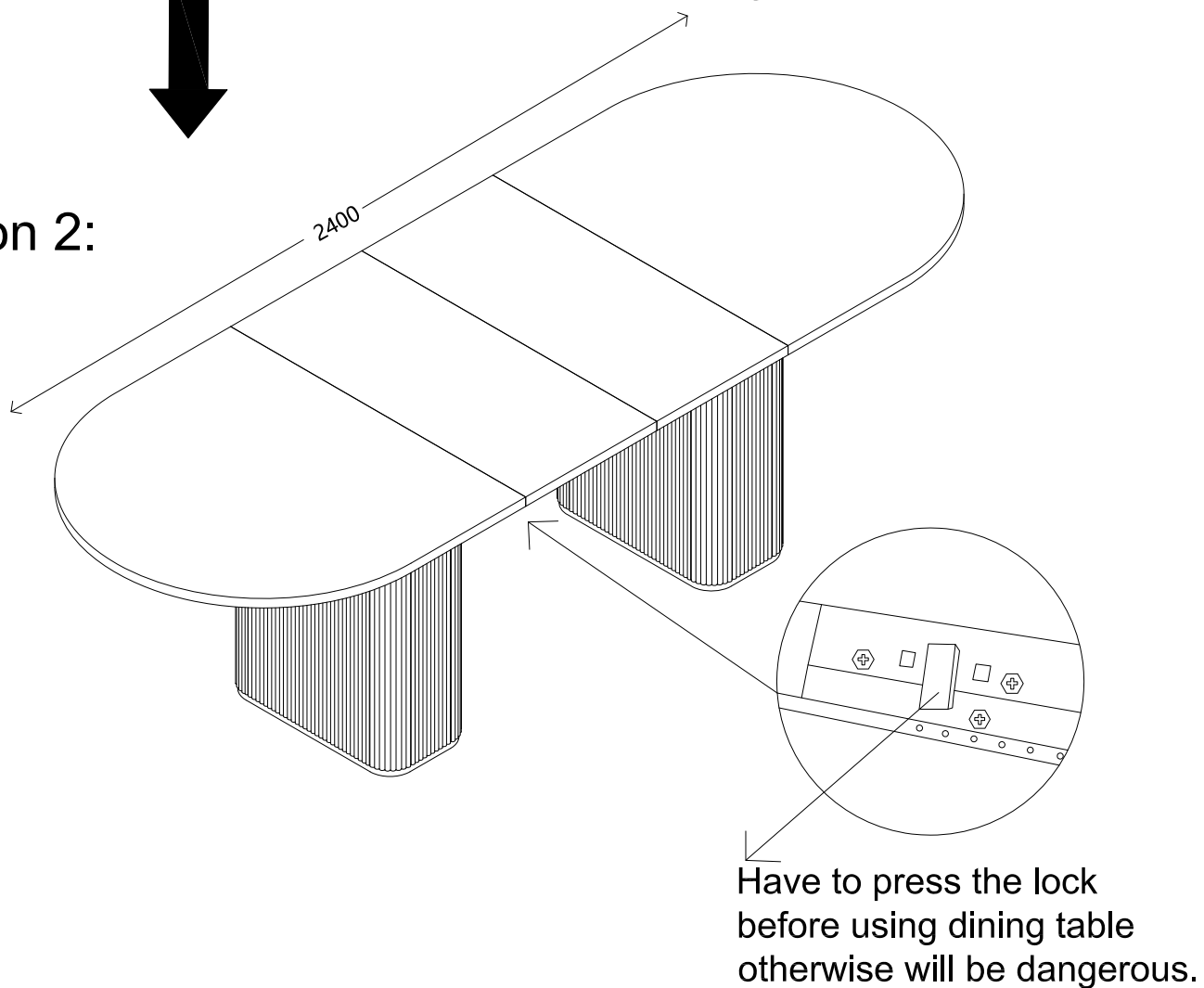

Great job. You're done!

Don't forget to share how it looks in  
your space and tag us on Instagram.

@lifelyhome #homewithlifely!