

# Assembly Instructions

## Ally Series

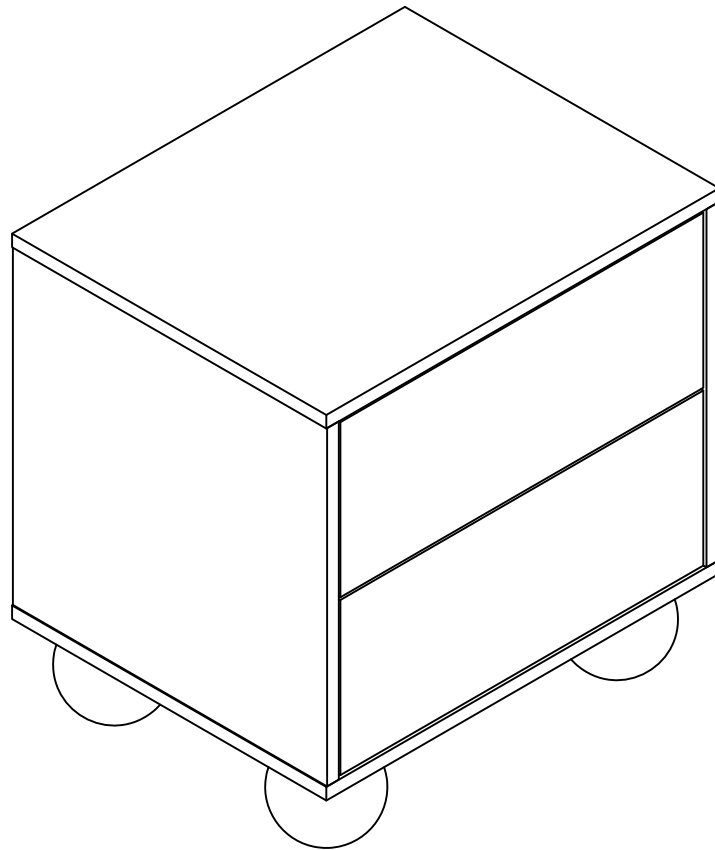

# Lifely\*

### Product Code

ALLY-BT-WHT Ally Bedside Table

### Dimensions(W x D x H)

500\*400\*530mm

---

### Important

Please read through instruction carefully  
Before assembly and keep for future reference.  
For our full catalogue of assembly instructions,  
Visit: [lifely.com.au/assembly](http://lifely.com.au/assembly).

# Important Tips and Maintenance

- 

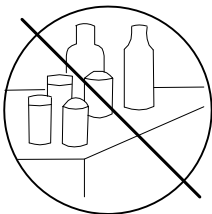
1. Keep children and animals away from working area as smaller parts may cause choking if swallowed.
- 

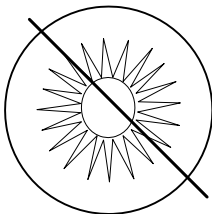
2. Never place liquids or anything damp upon furniture as it will mark. Ensure a coaster or running is beneath.
- 

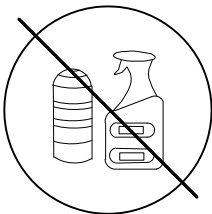
3. To avoid fading, keep furniture out of direct sunlight.
- 

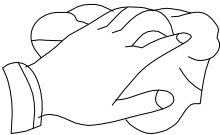
4. Never use ammonia based cleaning products as it will damage the finish.
- 

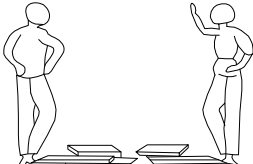
5. Use a soft or dry cloth when wiping or cleaning surfaces.
- 

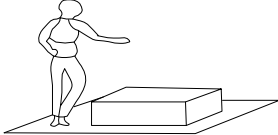
6. Two person are required.
- 

7. Lay a soft matt down to protect the furniture piece before and during assembly.

So your relationship is strong. But is it flat-pack furniture strong? Unless you're an aerospace engineer, assembling furniture can be slightly stressful. We recommend meditating quietly, pouring yourself a herbal tea (or slightly less herbal wine) and tackling things one step at a time. If you feel a passive aggressive remark coming on, try a compliment instead. E.g. "You're so good looking."

This 8-step assembly should take around 40 minutes with an Allen key-or 22 minutes with an electric drill.

Designed for everyday

Component Hardware

Please check you have all the fittings  
part or tools are listed in below.

No. A  
Quantity:18 Pcs  
Cam  
φ15\*12mm



No. B  
Quantity:18 Pcs  
Cam Lock Dowel  
φ7\*25



No. C  
Quantity:2 Sets  
L=250mm  
Push Slider

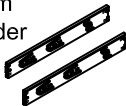

No. D  
Quantity:8 Pcs  
Screw  
φ3.5\*35mm



No. E  
Quantity:8 Pcs  
Wooden Dowel  
Ø8\*30mm



No. F  
Quantity:33 Pcs  
Screw  
φ3.5\*14mm



No. G  
Quantity:18 Pcs  
Cover  
φ20mm



No. H  
Quantity:6 Pcs  
EVA Pad  
φ25\*2mm



No. I  
Quantity:6 Pcs  
Ø3\*18mm

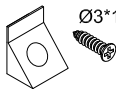

No. J  
Quantity:4 Pcs  
Screw  
M8\*30mm



No. K  
Quantity:1 Pc  
Key  
5mm

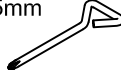

No. L  
Quantity:1 Pc  
Key  
5mm

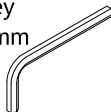

No. M  
Quantity:1 Pair  
Gloves



## Component Panels & part List

Please check you have all the panels  
are listed below.

1. Top Panel -----x1

2. Bottom -----x1

3. Side Panel-Left -----x1

4. Side Panel-Right -----x1

5. Back Panel -----x1

6. Drawer Panel -----x2

7. Drawer Side Panel-Left -----x2

8. Drawer Side Panel-Right -----x2

9. Drawer Back Panel -----x2

10. Drawer Bottom Panel -----x2

11. Leg -----x4

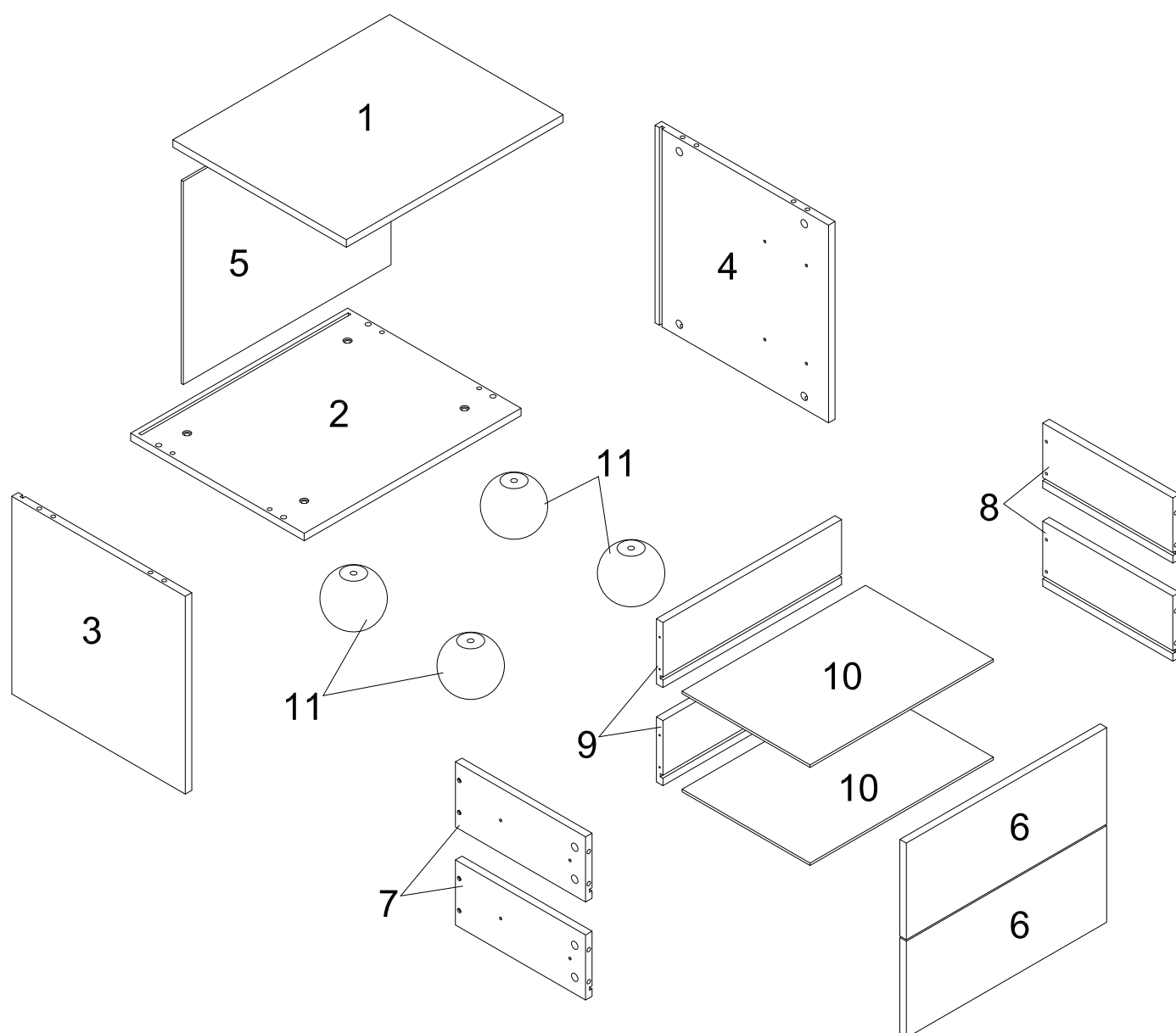

## STEP 1

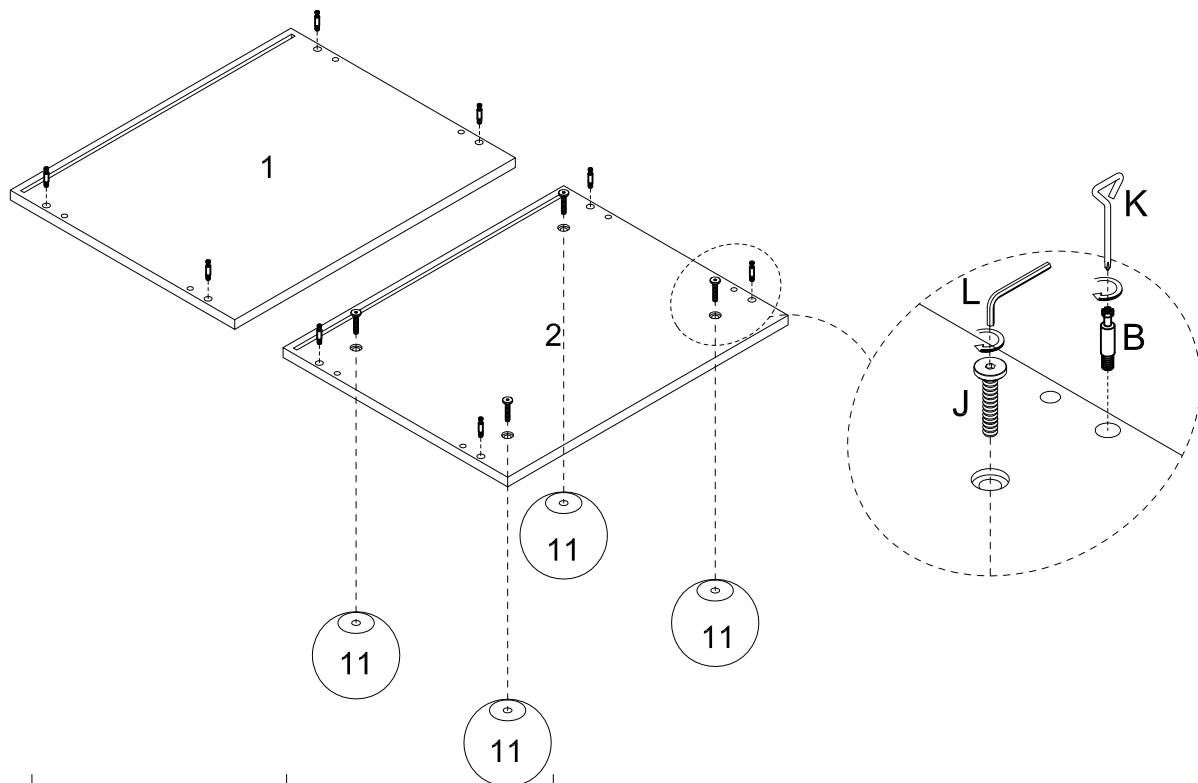

No. B  
Quantity:8 Pcs

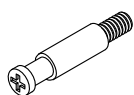

No. J  
Quantity:4 Pcs



No. K  
Quantity:1 Pc

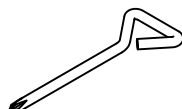

No. L  
Quantity:1 Pc

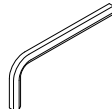

## STEP 2

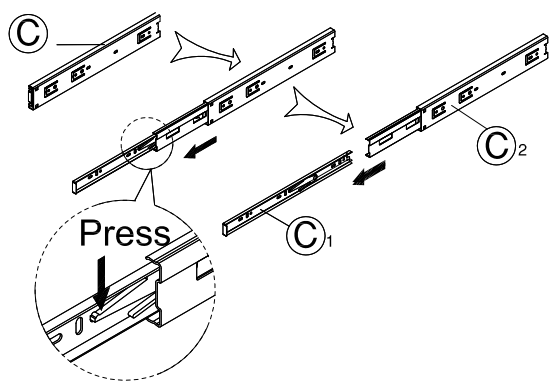

No. C  
Quantity:4 Pcs

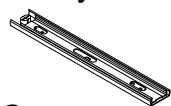

C<sub>2</sub>

No. F  
Quantity:16 Pcs



NOTE:Please through the hole in the center.

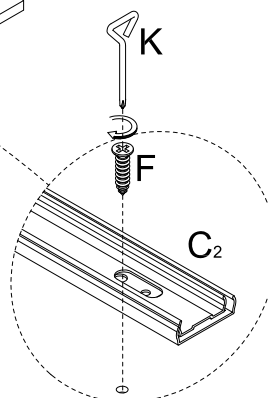
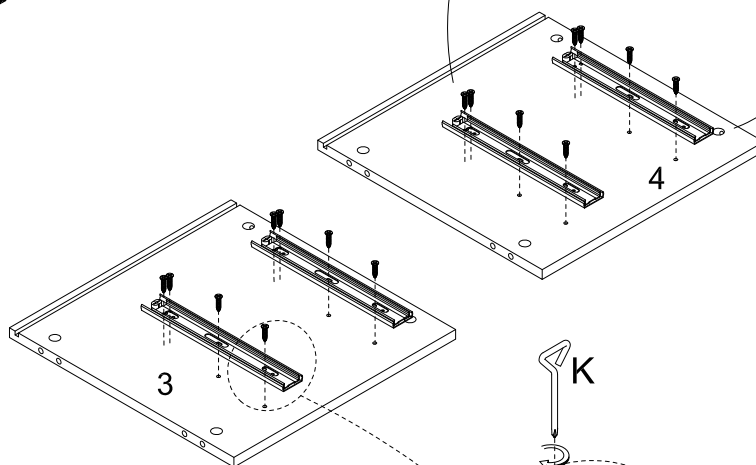
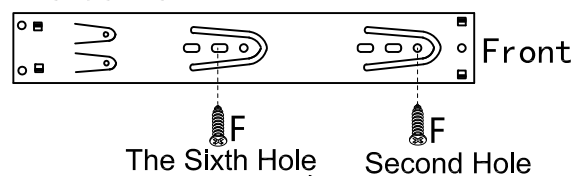

## STEP 3

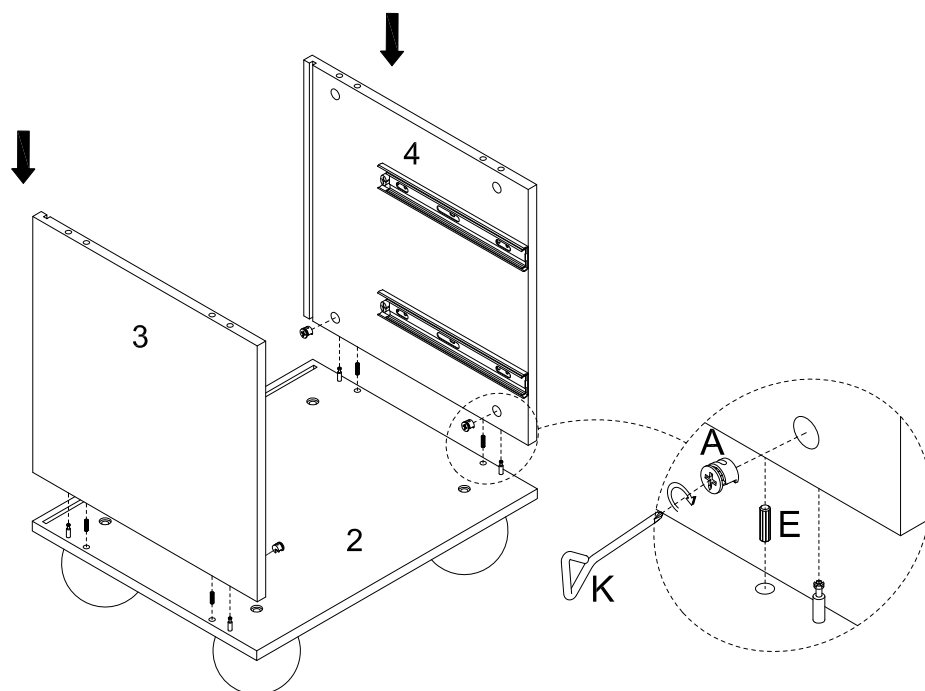

No. A  
Quantity:4 Pcs



No. E  
Quantity:4 Pcs

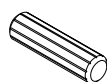

## STEP 4

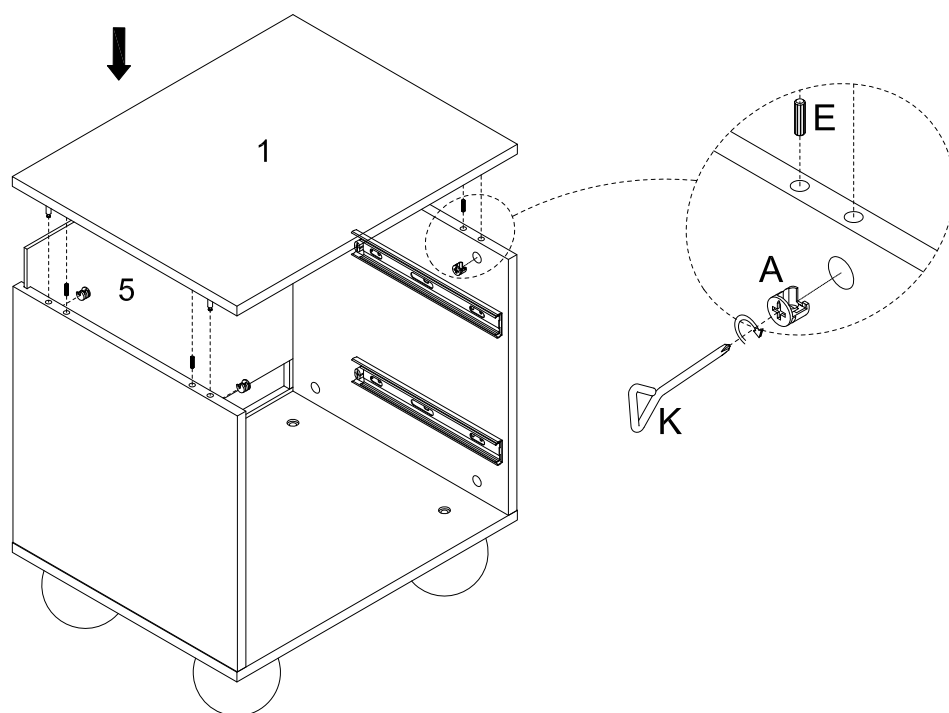

No. A  
Quantity:4 Pcs



No. E  
Quantity:4 Pcs

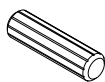

## STEP 5

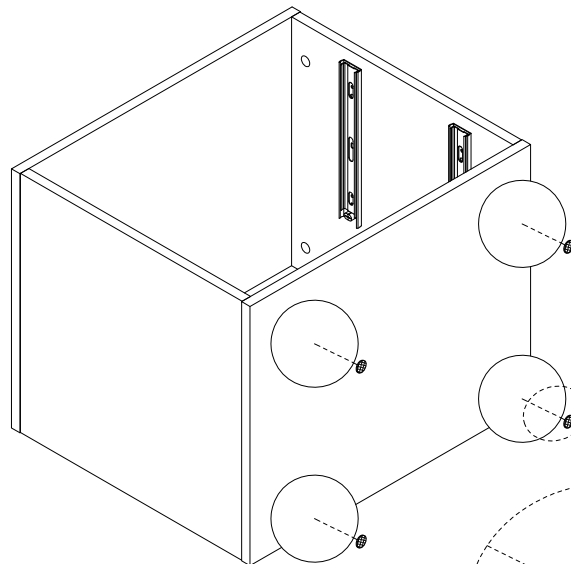

If the bottom is uneven,  
please add one more pads  
to adjust.

No. H  
Quantity:6 Pcs



NOTE:Please through the hole in  
the center.

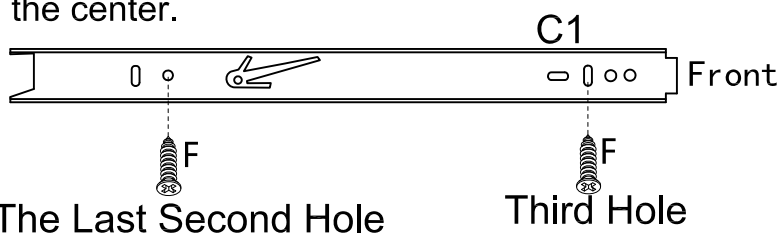

## STEP 6

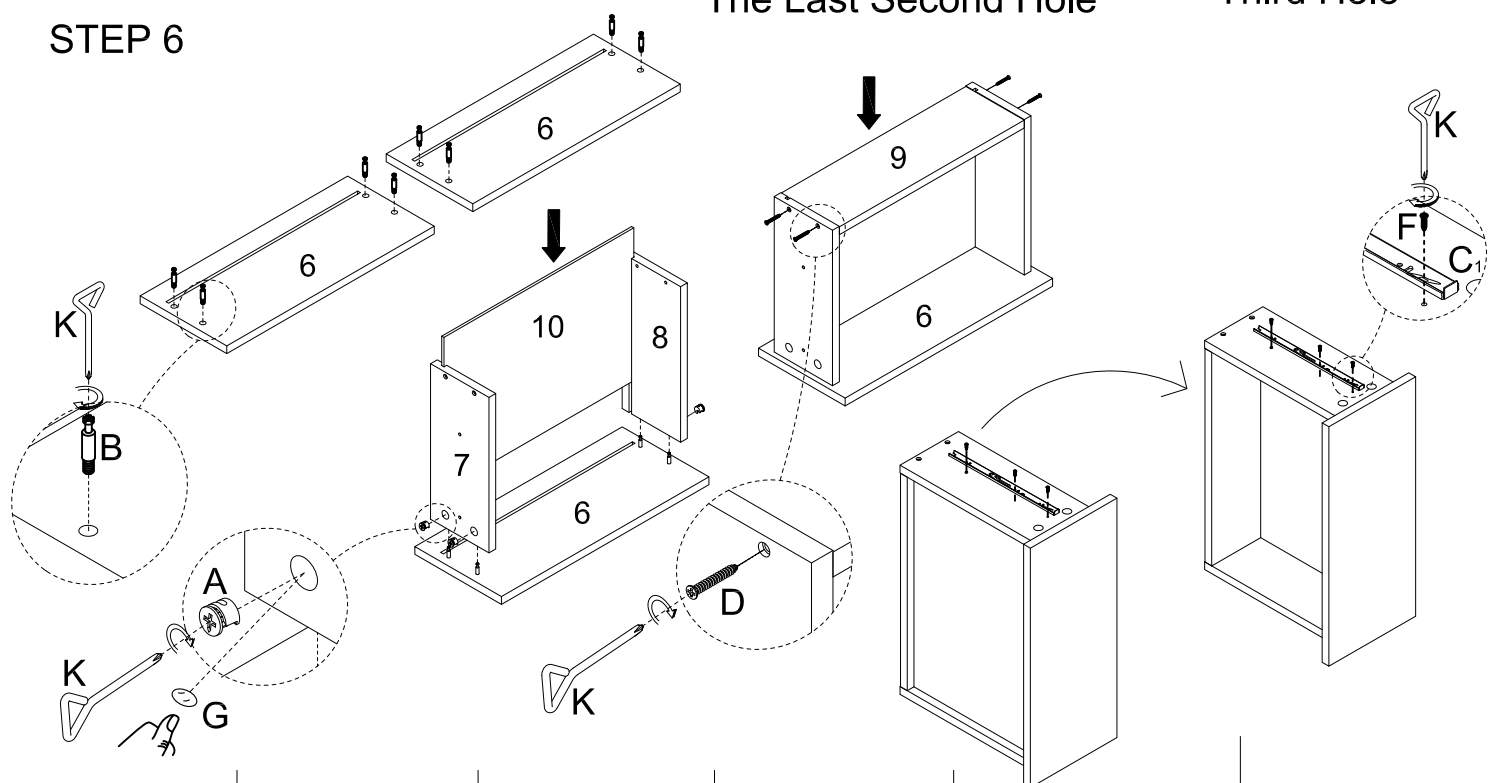

No. A  
Quantity:8 Pcs



No. B  
Quantity:8 Pcs

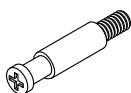

No. C  
Quantity:4 Pcs

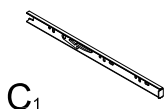

No. D  
Quantity:8 Pcs



No. F  
Quantity:12 Pcs



No. G  
Quantity:16 Pcs



ALLY-BT-WHT 8



## STEP 7

1, It might not be perfect aligned if push the edge of the drawers, when you find one of the corner of drawer panel not level please push one more time.

2, Please push the middle area of the drawers to open or close the drawers.

## NOTE:

For example:

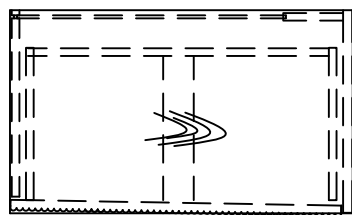

Push here will back normal.

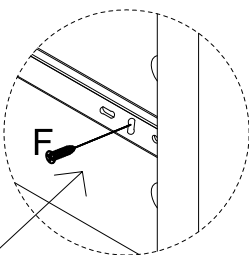

This screw can adjust the gap between the higher and lower, the position of screw remains the same, just loosen the slide rail up and down.

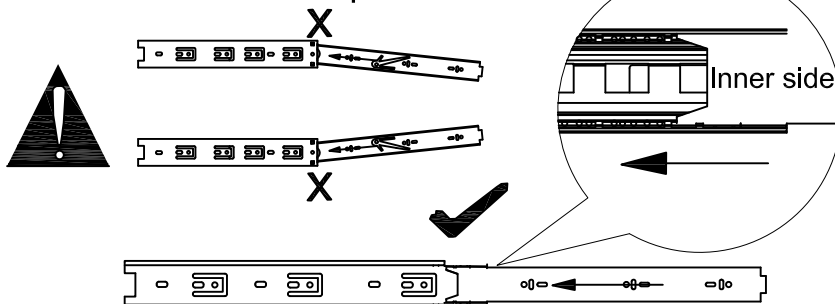

## Note:

Maximum Weight:6 Kgs

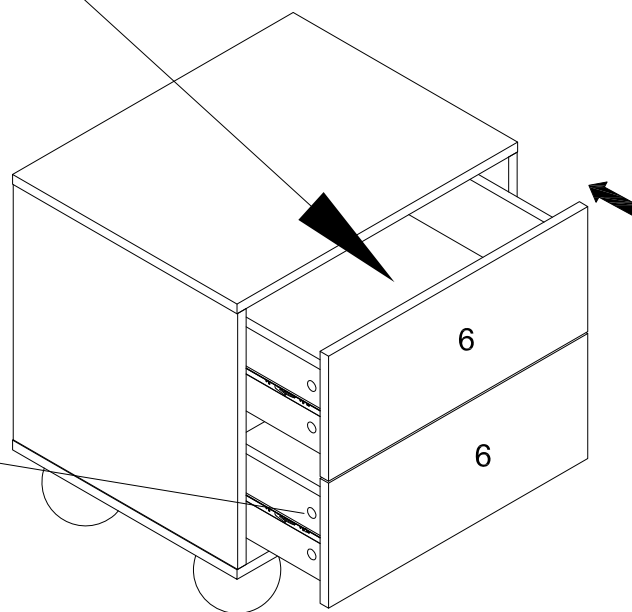

## STEP 8

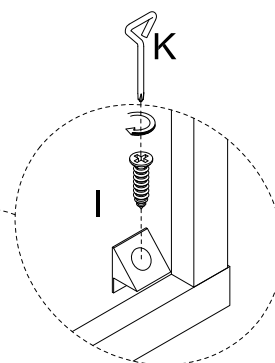
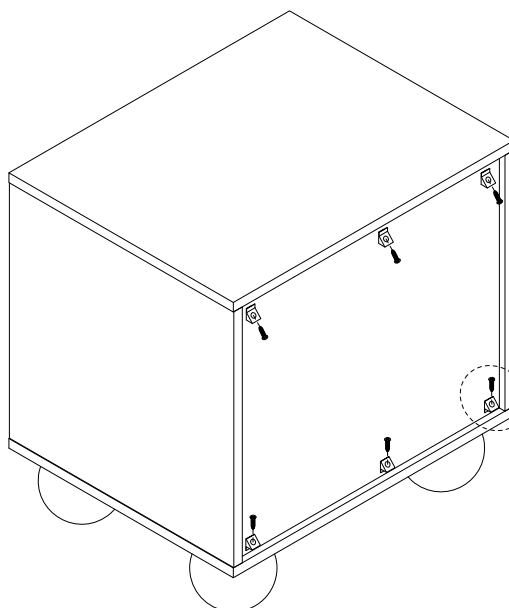

No. I

Quantity:6 Pcs



Great job. You're done!

Don't forget to share how it looks in  
your space and tag us on Instagram.

@lifelyhome #homewithlifely!