

Assembly Instructions

Ally Series

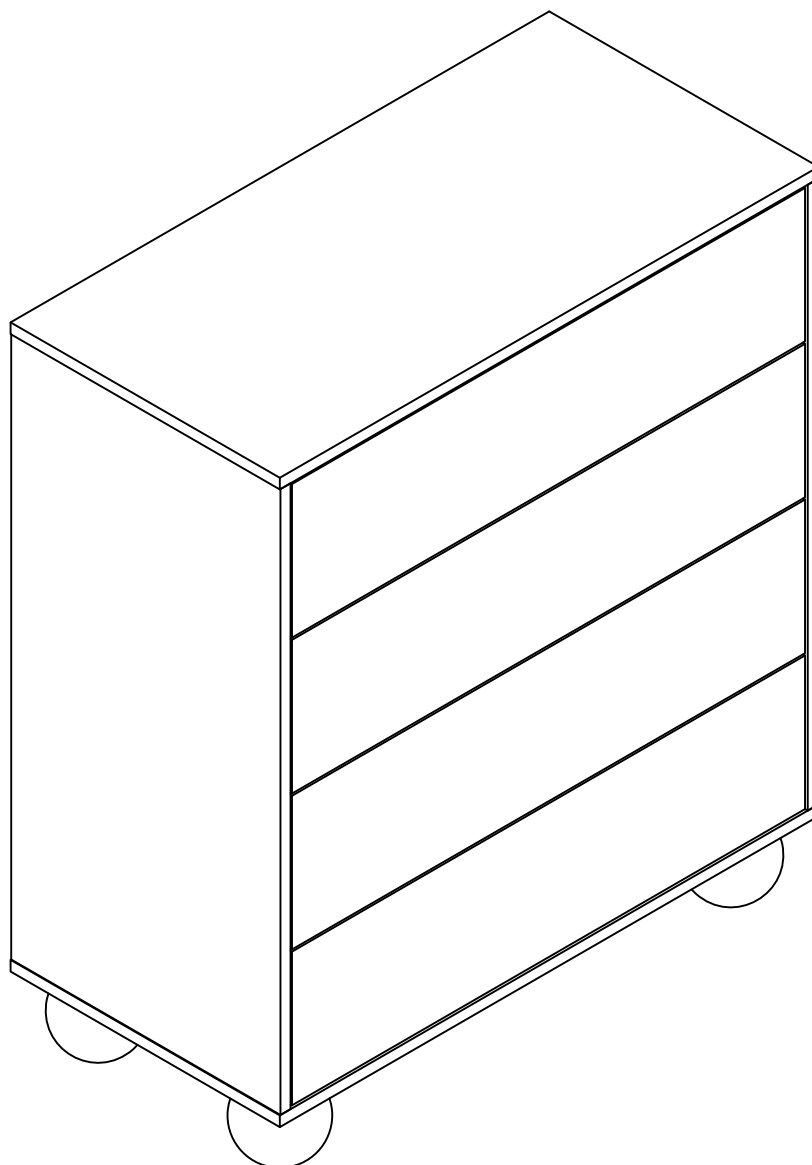

Lifely*

Product Code

ALLY-4COD-WHT Ally 4 Chest of Drawers

Dimensions(W x D x H)

800*400*940mm

Important

Please read through instruction carefully
Before assembly and keep for future reference.
For our full catalogue of assembly instructions,
Visit: lifely.com.au/assembly.

Important Tips and Maintenance

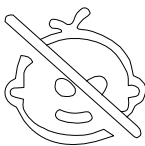

1.
Keep children and animals away from working area as smaller parts may cause choking if swallowed.

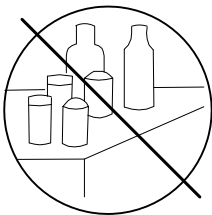

2.
Never place liquids or anything damp upon furniture as it will mark. Ensure a coaster or running is beneath.

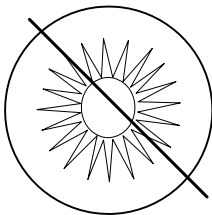

3.
To avoid fading, keep furniture out of direct sunlight.



4.
Never use ammonia based cleaning products as it will damage the finish.

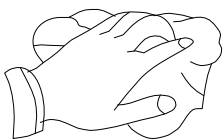

5. Use a soft or dry cloth when wiping or cleaning surfaces.

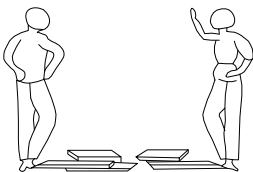

6.
Two person are required.

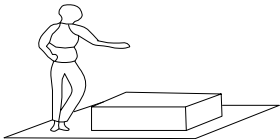

7.
Lay a soft matt down to protect the furniture piece before and during assembly.

So your relationship is strong. But is it flat-pack furniture strong? Unless you're an aerospace engineer, assembling furniture can be slightly stressful. We recommend meditating quietly, pouring yourself a herbal tea (or slightly less herbal wine) and tackling things one step at a time. If you feel a passive aggressive remark coming on, try a compliment instead. E.g. "You're so good looking."

This 9-step assembly should take around 55 minutes with an Allen key-or 35 minutes with an electric drill.

Designed for everyday

Component Hardware are in box 1

Please check you have all the fittings
part or tools are listed in below.

No. A
Quantity:56 Pcs
Cam
Ø15*12mm



No. B
Quantity:56 Pcs
Cam Lock Dowel
Ø7*25



No. C
Quantity:4 Sets
L=250mm
Push Slider

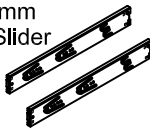

No. D
Quantity:19 Pcs
Screw
φ3.5*35mm



No. E
Quantity:9 Pcs
Wooden Dowel
Ø8*30mm



No. F
Quantity:65 Pcs
Screw
Ø3.5*14mm



No. G
Quantity:56 Pcs
Cover
Ø20mm



No. H
Quantity:10 Pcs
EVA Pad
Ø25mm



No. I
Quantity:1 Set

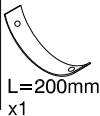

L=200mm
x1



Ø4*25mm x1



x1



Ø4 x2

No. J
Quantity:5 Pcs
Screw
M8*30mm



No. K
Quantity:1 Pc
Key
5mm



No. L
Quantity:1 Pc
Key
5mm

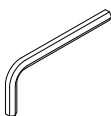

No. M
Quantity:1 Pair
Gloves



Component Panels & part List

Please check you have all the panels are listed below.

1. Top Panel-----x1 CTN 2/2	10. Leg -----x4 CTN 1/2
2. Bottom-----x1 CTN 2/2	11. Leg-Middle-----x1 CTN 1/2
3. Side Panel-Left-----x1 CTN 2/2	12. Drawer Panel-----x4 CTN 2/2
4. Side Panel-Right-----x1 CTN 2/2	13. Drawer Side Panel-Left---x4 CTN 1/2
5. Back Support Panel-----x2 CTN 2/2	14. Drawer Side Panel-Right--x4 CTN 1/2
6. Back Support Panel-Middle--x1 CTN 2/2	15. Drawer Back Panel-----x4 CTN 1/2
7. Back Panel-----x2 CTN 2/2	16. Drawer Bottom-----x4 CTN 1/2
8. Front Support-----x1 CTN 2/2	17. Drawer Support-----x4 CTN 1/2
9. Top Support-----x1 CTN 2/2	

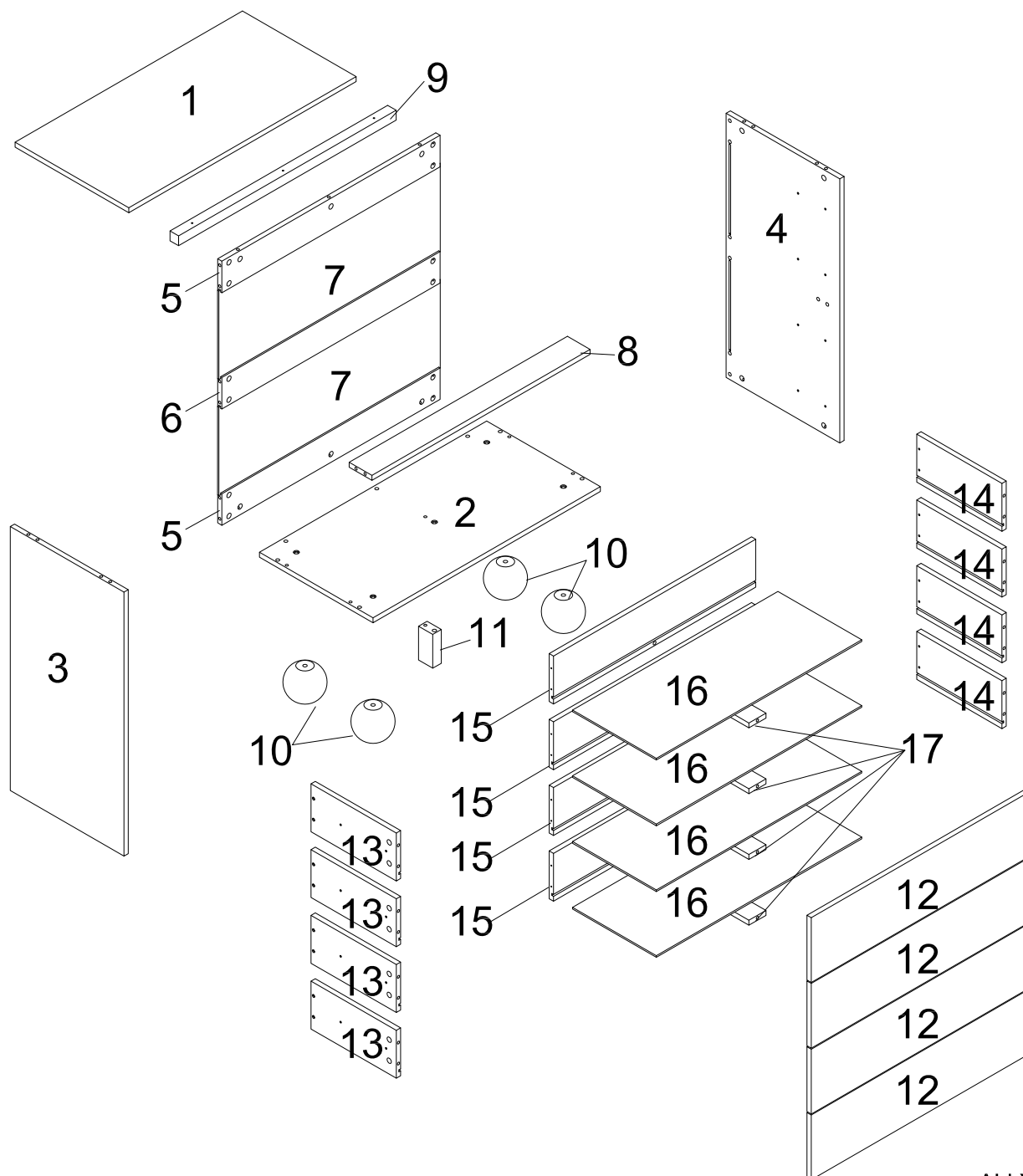

STEP 1

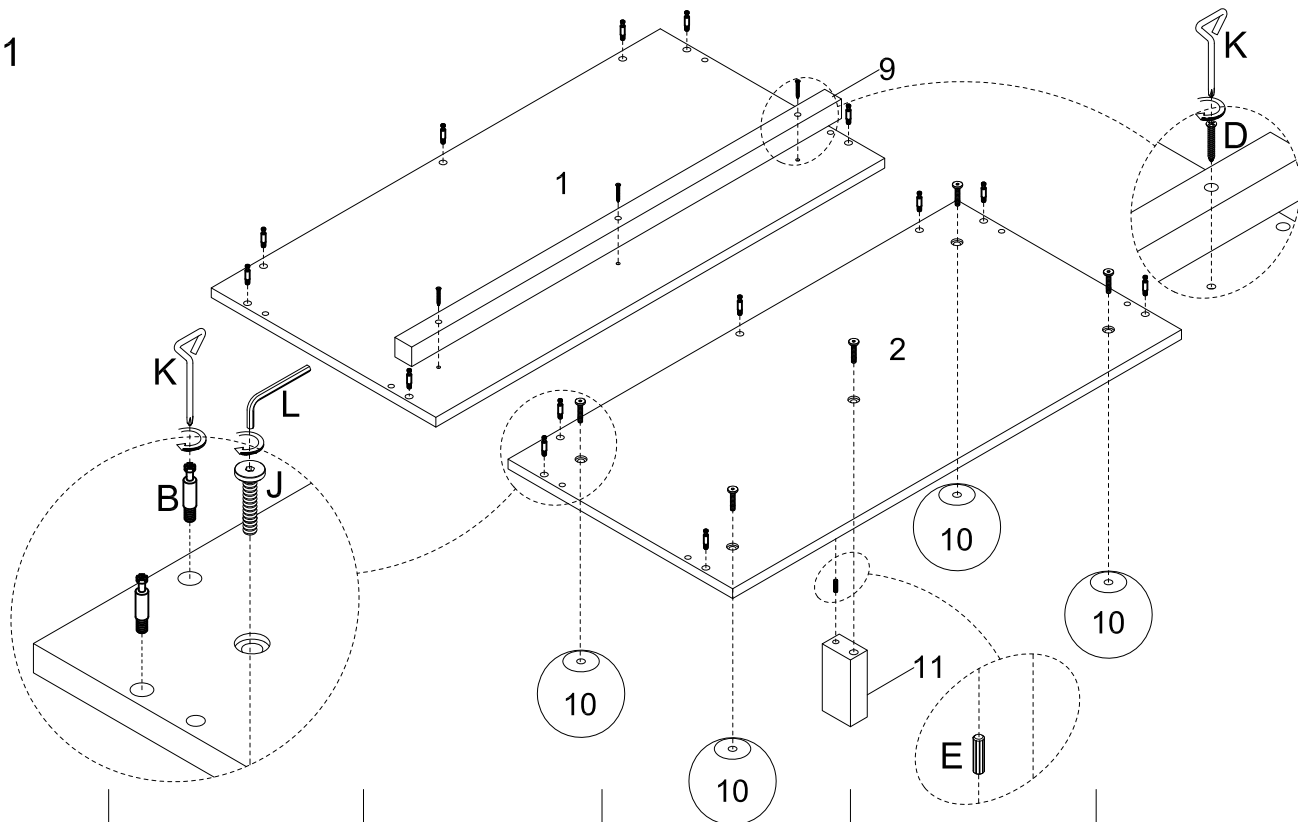

No. B
Quantity:14 Pcs

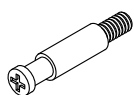

No. D
Quantity:3 Pcs



No. E
Quantity:1 Pc

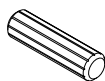

No. J
Quantity:5 Pcs



No. K
Quantity:1 Pc

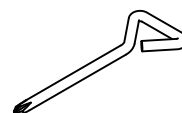

No. L
Quantity:1 Pc

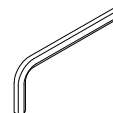

STEP 2

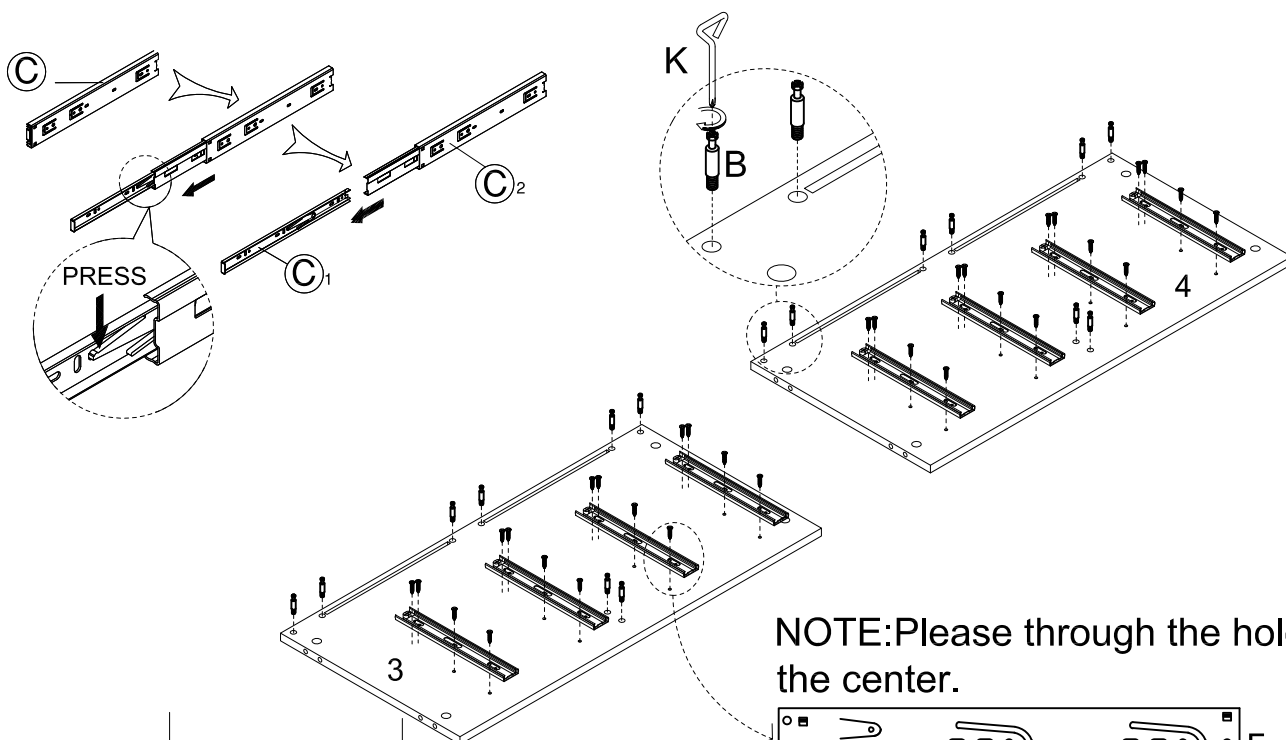

No. B
Quantity:16 Pcs

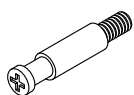

No. C
Quantity:8 Pcs

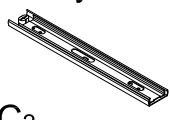

No. F
Quantity:32 Pcs



NOTE:Please through the hole in the center.

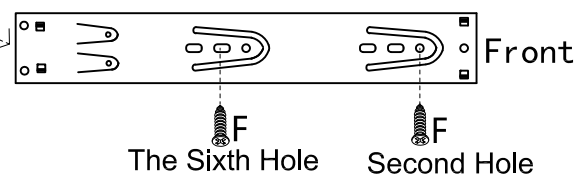

STEP 3

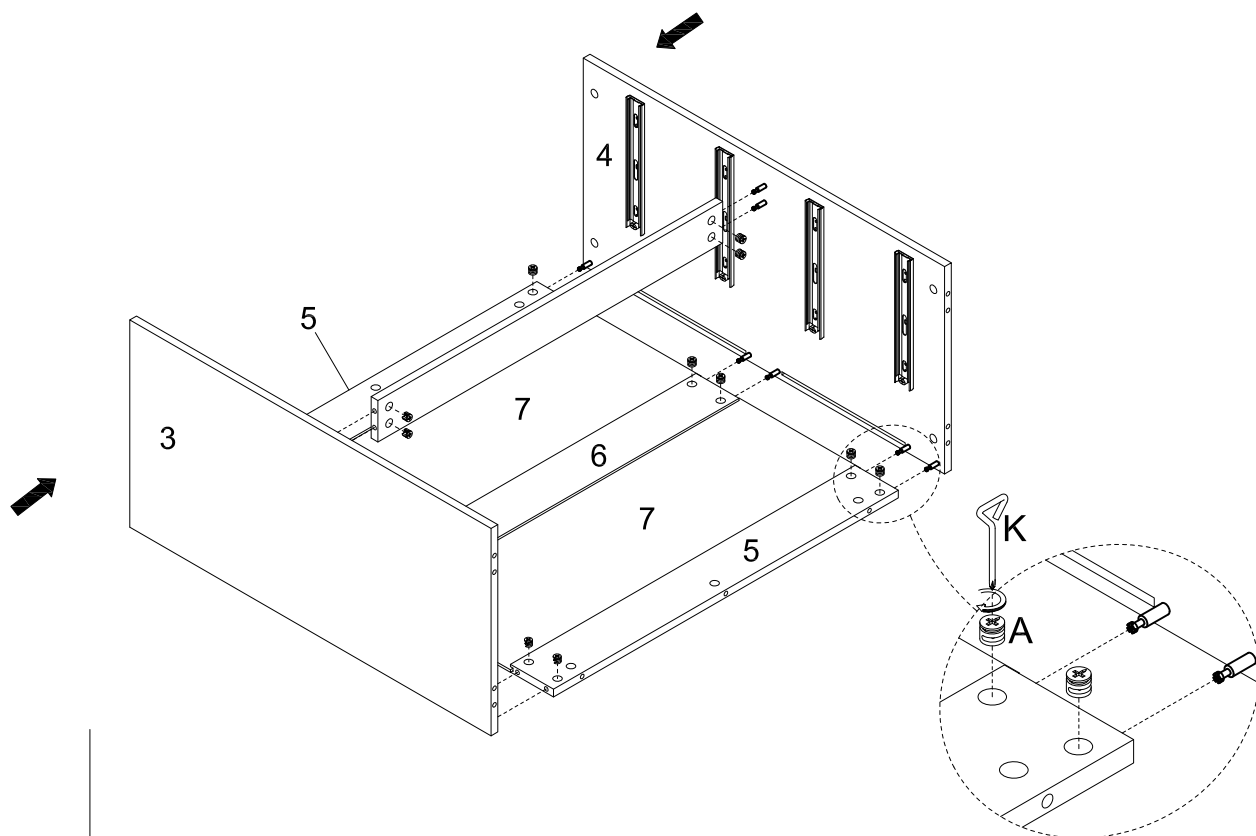

No. A
Quantity:16 Pcs



STEP 4

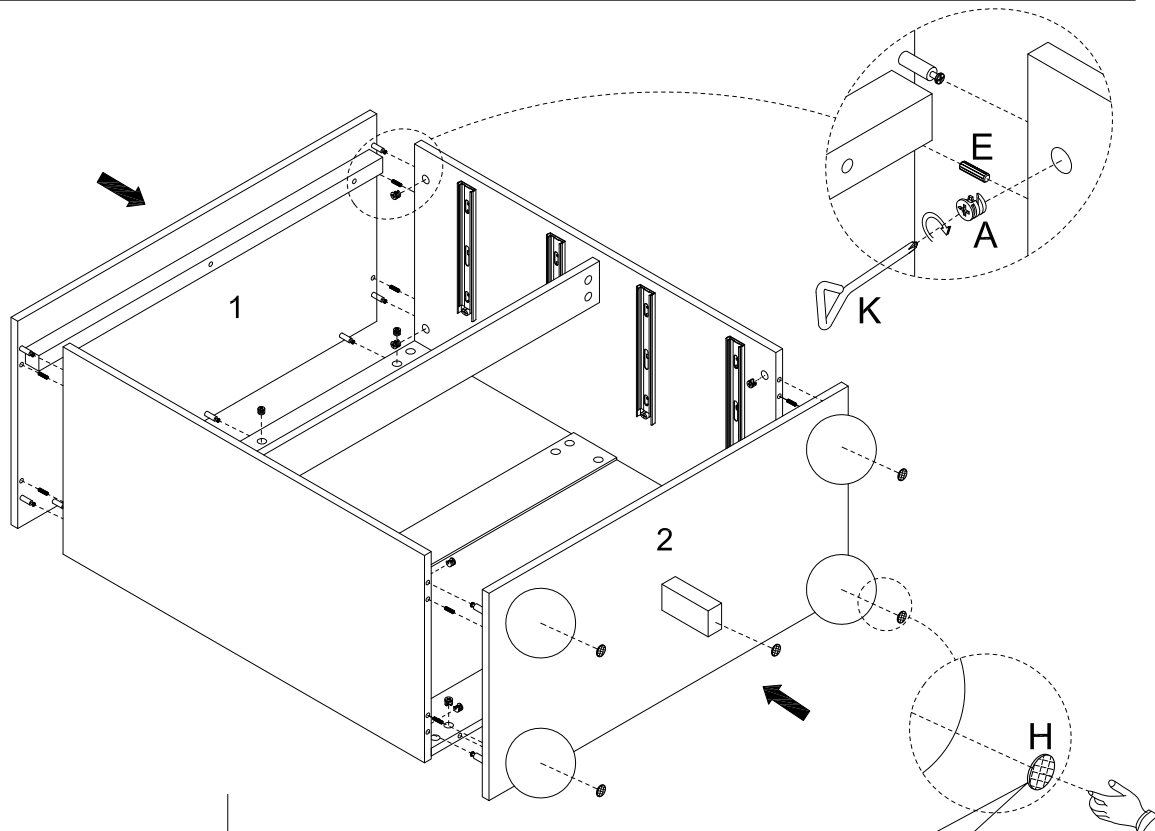

No. A
Quantity:14 Pcs



No. E
Quantity:8 Pcs

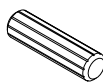

No. H
Quantity:5 Pcs



If the bottom is uneven,
please add one more pads
to adjust.

STEP 5

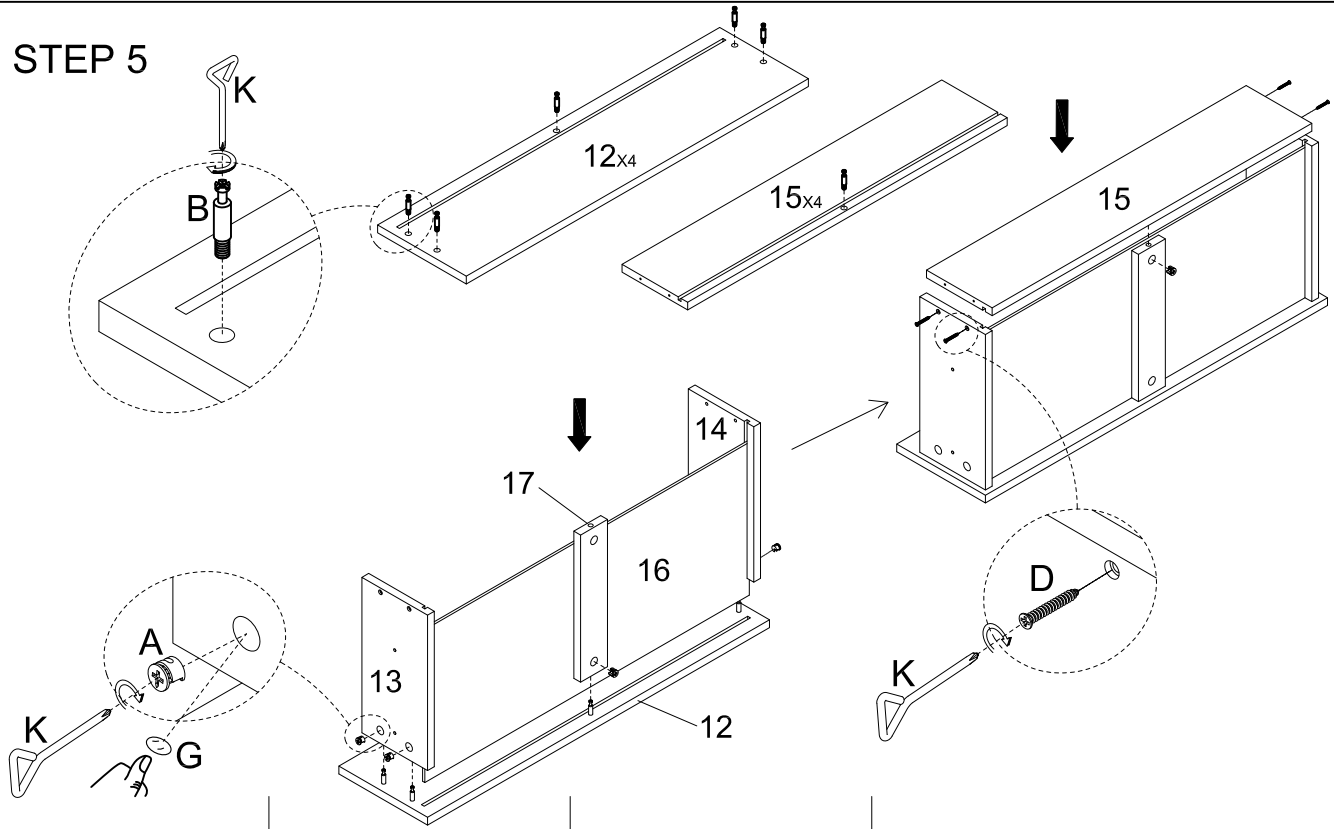

No. A

Quantity:24 Pcs



No. B

Quantity:24 Pcs

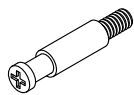

No. D

Quantity:16 Pcs



No. G

Quantity:54 Pcs



STEP 6

NOTE:Please through the hole in the center.

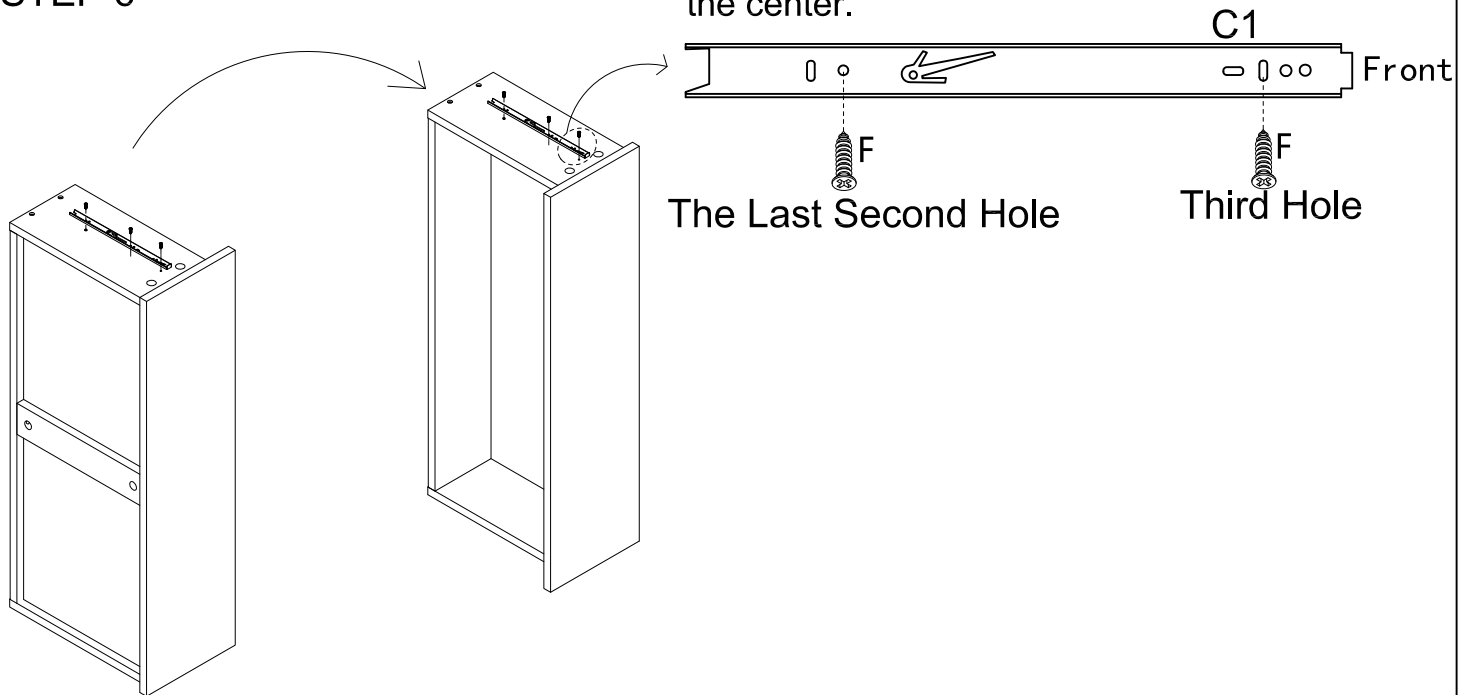

No. C

Quantity:8 Pcs

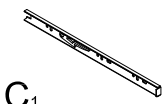

C₁

No. F

Quantity:24 Pcs



STEP 7

Note:
Maximum Weight:6 Kgs

This screw can adjust the gap between the higher and lower, the position of screw remains the same, just loosen the slide rail up and down.

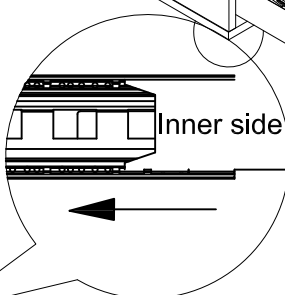
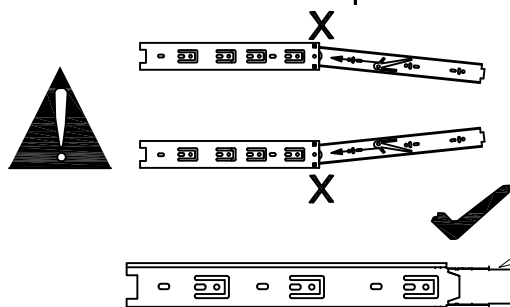
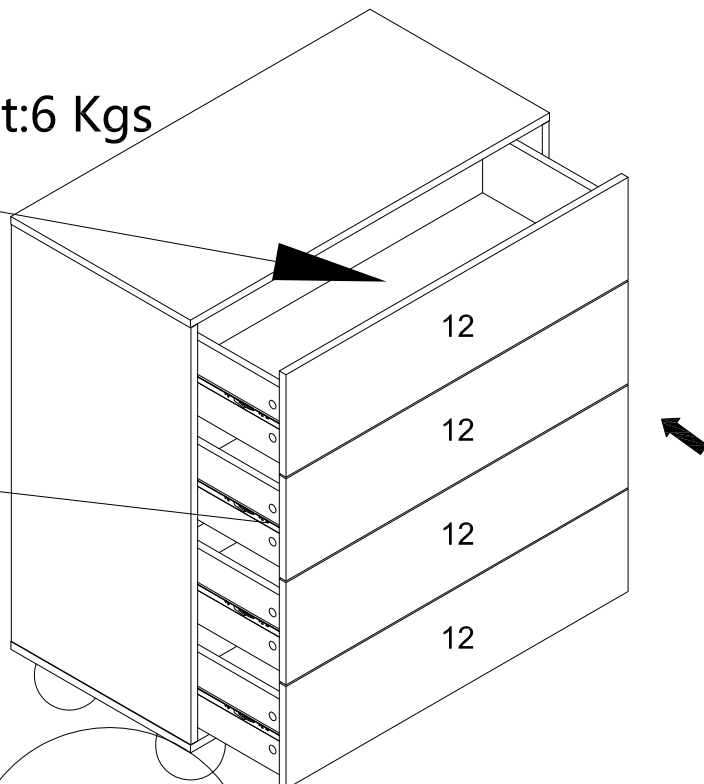
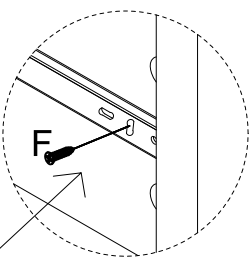

STEP 8

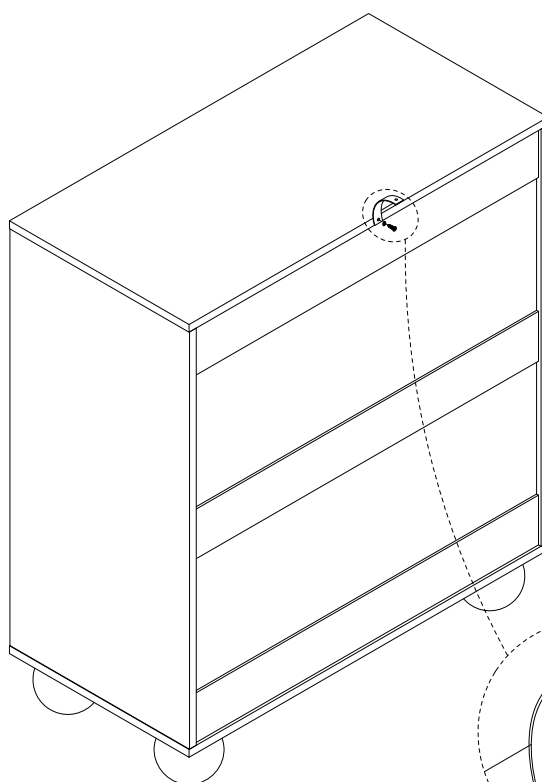

No. F
Quantity:1 Pc



No. I
Quantity:1 Pc



L=200mm

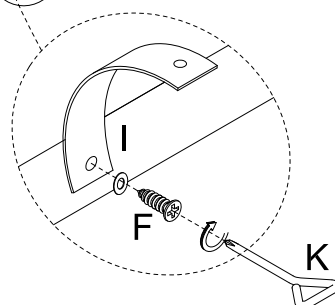

STEP 9

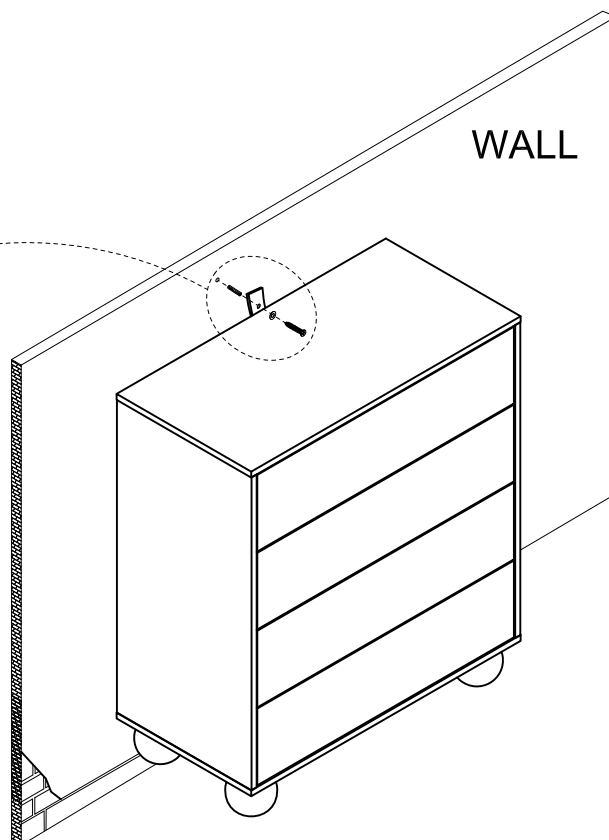
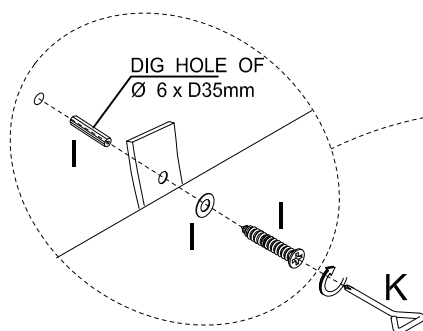

No. I

Quantity: 1 Pc

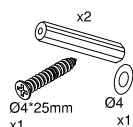

TOPPLING FURNITURE WARNING:

- It is strongly recommended that this product is permanently fixed to the wall.
- Please seek professional advice if you are in doubt of what fixing device to use.
- Regularly check that anchors are securely maintained.
- Stability of tall items may be affected by thick pile carpet or uneven floors .
- Do not place unanchored televisions on furniture .

CAUTION: for your safety when attaching the anchor fixings, please note the following:

- Check any electrical wires or plumbing inside the wall before drilling any holes (if you are unsure please seek professional advice from a qualified tradesperson).



WARNING: PLEASE SECURE YOUR FURNITURE WITH THE SUPPLIED WALL FIXING. SCAN THE CODE FOR MORE INFORMATION.



NOTE:

- 1, It might not be perfect aligned if push the edge of the drawers, when you find one of the corner of drawer panel not level please push one more time.

For example:

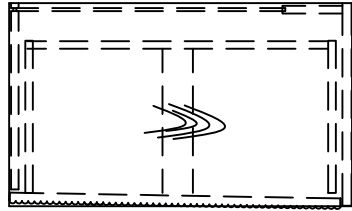

Push here will back normal.

- 2, Please push the middle area of the drawers to open or close the drawers.

- 3, Don't open all drawers otherwise may skew the chest.

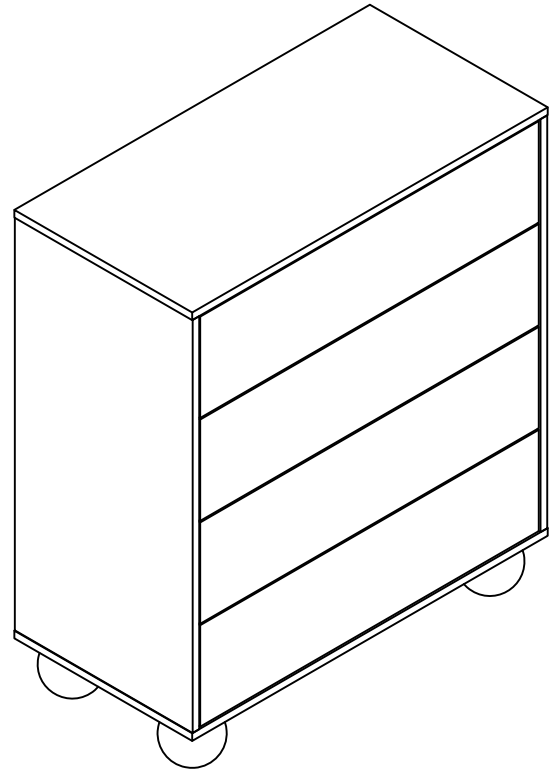

Great job. You're done!

Don't forget to share how it looks in
your space and tag us on Instagram.

@lifelyhome #homewithlifely!